

Single Disc LS160/LS160HD

Keep your business up and
running

Sales Presentation

LS160 and LS160HD



LS160



LS160HD

Content

• Purpose of the sales presentation	3
• Product definition	4
• Why launch LS160 and LS160HD in the market	5
• Customers and working environments	6
• Technical specifications	7
• Competitors comparison	8
• Machine structure	9
• Special features	10-12
• Summary of key product features	13

Purpose of the Sales Presentation

The purpose of the presentation is not only to introduce new Viper Single Disc products to you but provide you some selling tips and competitor comparison as well.

Product Definition— Model Names

Definition of the letters and numbers used in model name

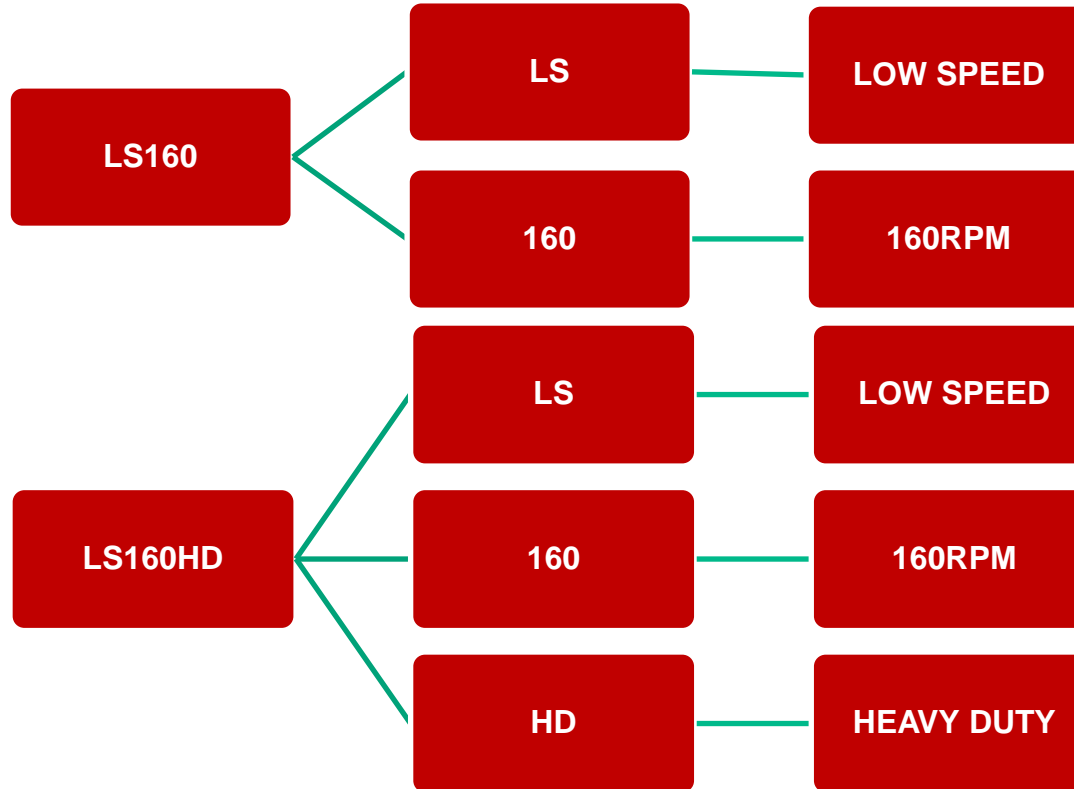

Why Launch the Machines in the Market

The LS160 and LS160HD are low speed single discs with below selling points:

- **High reliability**
- **Competitive pricing**
- **Value for money**
- **Well balance**
- **Powerful motors**



Customers and Working Environment

- **LS160/LS160HD series single disc is appropriate for**
 - **Hotels/restaurants**
 - **Shopping mall/exhibition center**
 - **Schools/government institutions**
 - **Other commercial environments.**
- **The machines are ideal for cleaning most types of floors: tiled floor, marble and carpet etc**

Technical Specifications LS160/160HD

Model	LS160	LS160HD
Rated power (W)	1300	1800
Voltage (V)	220-240V	
Frequency (Hz)	50Hz	
Brush/pad diameter	430mm	
Cleaning width	430mm	
Brush RPM	165 \pm 5	
Start at low voltage	187 V	
Tank capacity	10L	
Cable length	10m	
Wheel diameter	127mm (5")	

Competitors Comparison

Photo								
Model	Viper LS160	Viper LS160HD	Comac CM1817	Numatic NPR1523	Cleanfix Power Disc LS	Chaobao BD3A	Baiyun BF521	Viper Old SC for EU
Working width (Ø cm)	43	43	43	45	44	43	43	43
Brush (Ø cm)	43	43	43	45	44	43	43	43
Brush rpm	160	160	180	230	160	154	154	150
Tank capacity (L)	10	10	15	N/A	14	N/A	N/A	10
Power (W)	1300	1800	1100	1500	1200	1100	1800	750
Power supply (V/Hz)	220-240/50	220-240/50	230-240/50-60	230/50	230/50-60	220/50	220-240/50	230-240/50-60
Cable length (m)	10	10	N/A	N/A	12.5	12	12	15
Weight (kg)	33	36	40	30	30	36.8	45	43
Size (cm)	56x43X120	56x43X120	N/A	118.5 x 58 x 45	N/A	N/A	50x50x120	121x53.6x43

Machine Structure

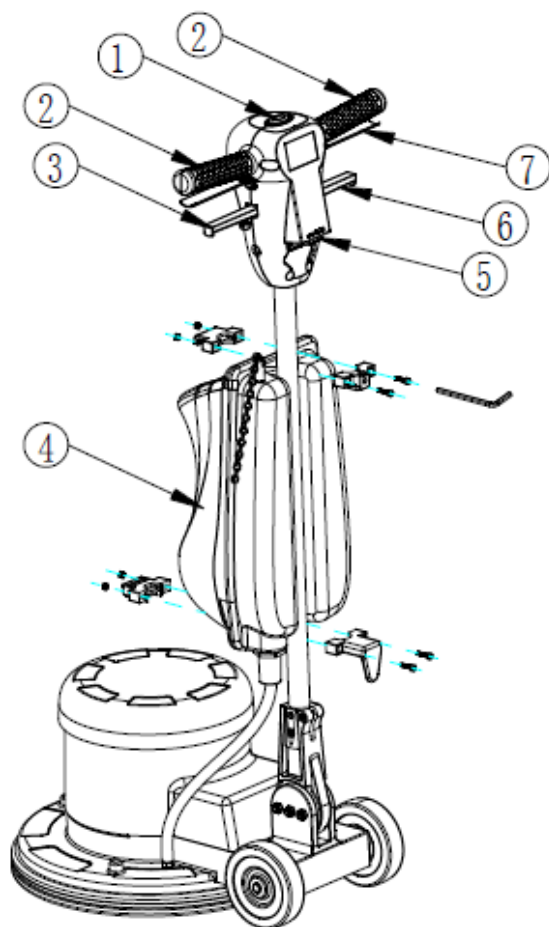

1. Safety switch
2. Handle grip
3. Accessory lever
4. Solution tank
5. Accessory power plug
6. Handle release lever
7. Trigger
8. Handle tube
9. Solution fitting
10. Weight

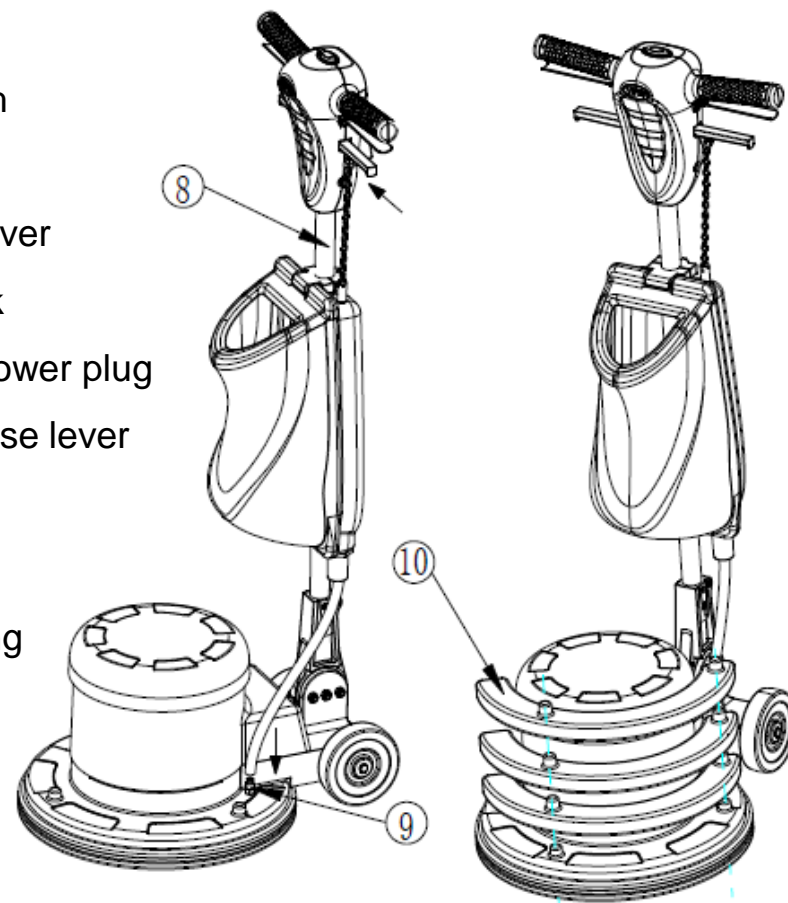

Special features

Ergonomic handle



The machine is automatically locked off when the handle is in 90 degree vertical position

Special features

- Waterproof cover

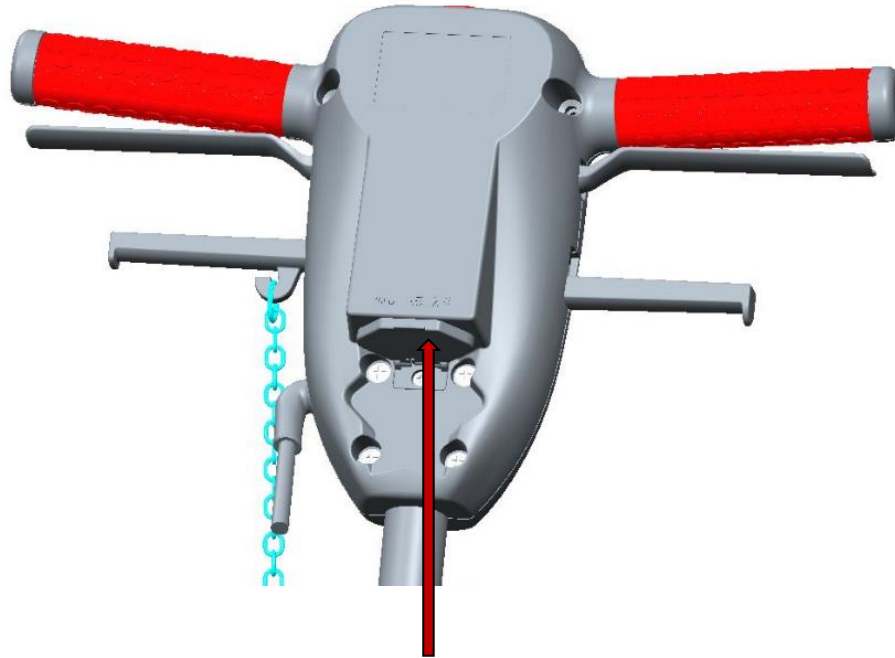

A waterproof cover is added to prevent from being electrocuted

Special features

Powerful motor

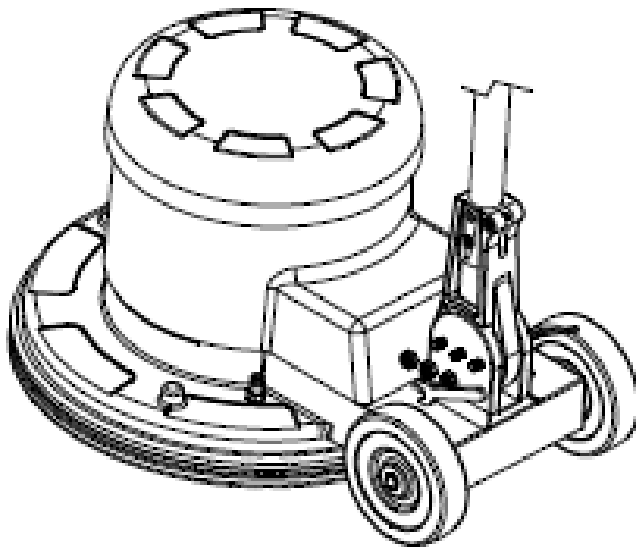

127mm rear wheels facilitate transport

Summary of key product features

- **Ergonomic handle**
- **Soft start system**
- **Safety lock-out switch**
- **Large rear wheels**
- **Well balanced compared to our competitors**
- **Powerful motor:**
 - **LS160: 1300W**
 - **LS160HD: 1800W**
- **Package deal, ready for use: tank, brush and pad holder are included**