

INSTRUCTIONS FOR USE

# DRYFT



Models No.:  
58002000, 58002001, 58002002, 58002003

User Manual P/N: 58002111

Rev. A Dec.2024



# NILFISK

**NILFISK**

EU / UE / EL / EC / EE / ES / EÚ / AB / EG

**Declaration of Conformity**

Prohlášení o shodě  
Konformitätserklärung  
Overensstemmelseserklæring  
Declaración de conformidad  
Vastavusdeklaratsioon  
Déclaration de conformité  
Vaatumusten mukaisuusvakuutus

Декларация за съответствие  
Δήλωση συμμόρφωσης  
Megfelelősségi nyilatkozat  
Izjava o skladnosti  
Dichiarazione di conformità  
Atitikties deklaracija  
Atbilstības deklarācija  
Samsvarserklæring

Conformiteitsverklaring  
Declaração de conformidade  
Deklaracja zgodności  
Declaratie de conformitate  
Försäkran om överensstämmelse  
Vyhlásenie o zhode  
Izjava o skladnosti  
Uygunluk beyanı

**Manufacturer** / Výrobce / Hersteller / Fabrikant / Fabricante / Κατασκευαστής / Gyártó / Proizvođač / Fabbrikante / Gamintojas / Ražotājs / Produsent / Fabrikant / Fabricante / Producent / Producător / Tillverkaren / Výrobca / Proizvajalec / Üretici firma:

**Nilfisk A/S, Marmorvej 8  
DK-2100 Copenhagen Ø, DENMARK**

**Product** / Produkt / Producto, Toode, Produit, Tuote / Προϊόν / Termék / Proizvod / Prodotto / Produkta / Produkts / Artikel / Produtos / Produs / Izdelek / Ürün

**Dryft**

**Description** / Popis / Beschreibung / Beskrivelse / Descripción / Kirjeldus / La description / Kuvaus / Описание / Περιγραφή / Leirás / Opis / Descrizione / Aprašymas / Apraksts / Beschrijving / Descrição / Descriere / Beskrivning / Popis / Açıklama

**FC - Floor Scrubber/Sweeper - Battery  
Charging mode: 100-240V 50-60Hz; Working  
mode: 24 VDC, IPX3**

**EN** We, Nilfisk hereby declare under our sole responsibility, that the above-mentioned product(s) is/are in conformity with the following directives and standards.

**BG** Ние, Nilfisk с настоящото декларираме на своя лична отговорност, че посочените по-горе продуктът е в съответствие със следните директиви и стандарти.

**NL** We verklaren Nilfisk hierbij op eigen verantwoordelijkheid, dat het bovengenoemde product voldoet aan de volgende richtlijnen en normen

**CS** My, Nilfisk prohlašujeme na svou výlučnou odpovědnost, že výše uvedený výrobek je ve shodě s následujícími směrnici a normami.

**EL** Εμείς, Nilfisk δηλώνουμε με αποκλειστική μας ευθύνη, ότι το προαναφερόμενο προϊόν συμμορφώνεται με τις ακόλουθες οδηγίες και πρότυπα.

**PT** Nós, a Nilfisk declaramos, sob nossa exclusiva responsabilidade, que o produto acima mencionado está em conformidade com as diretrizes e normas a seguir.

**DE** Wir, Nilfisk erklären in alleiniger Verantwortung, dass das oben genannte Produkt den folgenden Richtlinien und Normen entspricht.

**HU** Mi, Nilfisk kijelentjük, egyedüli felelősséggel, hogy a fent említett termék megfelel az alábbi irányelveknek és szabványoknak

**PL** My, Nilfisk Niniejszym oświadczamy z pełną odpowiedzialnością, że wyżej wymieniony produkt jest zgodny z następującymi dyrektywami i normami..

**DA** Vi, Nilfisk erklærer hermed under eget ansvar at ovennævnte produkt(er) er i overensstemmelse med følgende direktiver og standarder.

**HR** Mi, Nilfisk izjavljujemo pod punom odgovornošću, da gore navedeni proizvod u skladu sa sljedećim direktivama i standardima.

**RO** Noi, Nilfisk Prin prezenta declarăm pe propria răspundere, că produsul mai sus menționat este în conformitate cu următoarele standarde și directive.

**ES** Nosotros, Nilfisk declaramos bajo nuestra única responsabilidad que el producto antes mencionado está en conformidad con las siguientes directivas y normas

**IT** Noi, Nilfisk dichiara sotto la propria responsabilità, che il prodotto di cui sopra è conforme alle seguenti direttive e norme.

**SV** Vi Nilfisk förklarar härmed under eget ansvar att ovan nämnda produkt överensstämmer med följande direktiv och normer.

**ET** Meie, Nilfisk Käesolevaga kinnitame ja kanname ainuisikulist vastutust, et eespool nimetatud toode on kooskõlas järgmiste direktiivide ja

**LT** Mes, „Nilfisk“, prisiimdami visišką atsakomybę pareiškiamo, kad pirmiau minėtas produktas (-ai) atitinka šias direktyvas ir standartus

**SK** My, Nilfisk prehlasujeme na svoju výlučnú zodpovednosť, že vyššie uvedený výrobok je v zhode s nasledujúcimi smernicami a normami.

**FR** Nilfisk déclare sous notre seule responsabilité que le produit mentionné ci-dessus est conforme aux directives et normes suivantes.

**LV** Mēs, Nilfisk, ar pilnu atbildību apliecinām, ka iepriekšminētais produkts atbilst šādām direktīvām un standartiem

**SL** Mi, Nilfisk izjavljamo s polno odgovornostjo, da je zgoraj omenjeni izdelek v skladu z naslednjimi smernicami in standardi.

**FI** Me, Nilfisk täten vakuutamme omalla vastuulla, että edellä mainittu tuote on yhdenmukainen seuraavien direktiivien ja standardien mukaisesti

**NO** Vi, Nilfisk erklærer herved under eget ansvar, at det ovennevnte produktet er i samsvar med følgende direktiver og standarder

**TR** Nilfisk, burada yer alan tüm sorumluluklarımıza göre, yukarıda belirtilen ürünü aşağıdaki direktifler ve standartlara uygun olduğunu beyan ederiz.

2006/42/EC

EN 60335-1:2012+A11:2014+A13:2017+A1:2019+A14:2019+A2:2019+A15:2021+A16:2023  
EN 60335-2-72:2012

2014/30/EU

EN 61000-6-2:2019  
EN 61000-6-3:2021

Authorized to compile Technical File and signatory:

Dec 5, 2024

Sergio Coccapani, Head European FloorCare R&D Center

## TABLE OF CONTENTS

<b>INTRODUCTION.....</b>	<b>2</b>
ABOUT THIS MANUAL .....	2
TECHNICAL INFORMATION .....	2
IDENTIFICATION DATA .....	2
SPARE PARTS AND MAINTENANCE .....	3
CHANGES AND IMPROVEMENTS .....	3
OPERATION CAPABILITIES .....	3
UNPACKING.....	3
TRANSPORTING .....	4
<b>SAFETY.....</b>	<b>4</b>
WARNING SYMBOLS.....	4
SAFETY BASICS.....	5
OTHER SYMBOLS EXPLAINED .....	6
<b>MACHINE DESCRIPTION.....</b>	<b>8</b>
KNOW YOUR EQUIPMENT .....	8
CONTROL PANEL.....	9
<b>QUICK START GUIDE .....</b>	<b>10</b>
HOW DRYFY WORKS.....	11
HOW TO USE DRYFY .....	11
WHERE TO USE DRYFY .....	11
MAINTAINING CORRECT POSTURE.....	12
<b>TECHNICAL DATA .....</b>	<b>13</b>
TECHNICAL SPECIFICATION .....	Error! Bookmark not defined.
WIRING DIAGRAM .....	15
<b>MAINTENANCE .....</b>	<b>16</b>
BATTERY .....	16
ABOUT BATTERY .....	16
SAFETY BASICS.....	16
BATTERY INDICATION LIGHTS .....	17
BATTERY HANDLING .....	18
CHARGING YOUR DRYFT BATTERY .....	18
MAGPLATE AND PADS .....	19
PADS AND APPLICATIONS.....	23
PAD CLEANING .....	23
CHANGING YOUR MAGPLATES AND PADS.....	23
SQUEEGEE .....	24
HOW TO REMOVE THE SQUEEGEE .....	24
SOLUTION TANK.....	19
CLEANING.....	19
PREPARING CLEANING SOLUTION .....	20
MAGNETIC RECOVERY TANK .....	21
CLEANING.....	21
INLET FILTER SERVICE AND REPAIRS .....	22
CLEANING WITH DRYFT .....	26
STORING THE MACHINE .....	27
SCHEDULED MAINTENANCE TABLE.....	28
<b>TROUBLESHOOTING.....</b>	<b>29</b>
<b>SCRAPPING .....</b>	<b>30</b>

**INTRODUCTION**



**NOTE!**

*The numbers in brackets refer to the components shown in Machine Description chapter.*

**ABOUT THIS MANUAL**

The purpose of this Manual is to provide the operator with all necessary information to use the machine properly, in a safe and autonomous way. Before performing any procedure on the machine, the operators and qualified technicians must read this Manual carefully. Contact Nilfisk in case of doubts concerning the interpretation of the instructions and for any further information.

**TECHNICAL INFORMATION**

DRYFT, a breakthrough in floor cleaning technology, the world's first S-Motion Scrubber Dryer, has been developed for use by professional cleaning teams. With its patented ultra low-profile head shape and groundbreaking 4200rpm Scrubbing Technology, DRYFT delivers 100% floor cleaning coverage in half the time.

DRYFT cleans in widths of 160cm whilst you walk forward once, in comparison to other scrubbers, that require the user to walk four times up and down to cover this same cleaning width. The result is 75% less walking with DRYFT allowing the user to double their floor cleaning productivity.

DRYFT's cleaning pads are magnetically connected to the oscillating body. DRYFT is intended for commercial use, for facilities management companies, in hotels, schools, hospitals, factories, offices, shops and all commercial environments.

Our manual has been designed to help you safely and effectively get started with DRYFT. It includes technical instructions and guidance on how to set up and operate your machine, in addition to storage and maintenance.



**NOTE**

*Two copies of the original declaration of conformity are provided together with the machine documentation.*

**IDENTIFICATION DATA**

The machine serial number and model name are marked on the plate.

Year of production and model number are marked on the same plate.

This information is useful when requiring machine spare parts. Use the following table to write down the machine identification data.

<b>Model</b> .....
<b>Model number</b> .....
<b>Serial number</b> .....

NILFISK

**Serial No.:**  
NIL-EU-00001

**Date code:** 10/2024

**Model:** NILFISK  
DRYFT V1 EU

**Part No.:** 58002000

**Voltage:** 24 VDC

**G V W:** 22lb/10 kg

**IPX3**  
**168W**

**Only for use with battery:**  
BATTERY LI-ION DRYFT

Nilfisk A/S, Marmorvej 8  
DK-2100 Copenhagen Ø  
[www.nilfisk.com](http://www.nilfisk.com)

Made in Great Britain

## SPARE PARTS AND MAINTENANCE

All necessary operating, maintenance and repair procedures must be performed by qualified personnel or by Nilfisk Service Centers. Only original spare parts and accessories must be used. Contact Nilfisk for service or to order spare parts and accessories, specifying the model's name, model number and serial number.

## CHANGES AND IMPROVEMENTS

Nilfisk constantly improves its products and reserves the right to make changes and improvements at its discretion without being obliged to apply such benefits to the machines that were previously sold. Any change and/or addition of accessory must be approved and performed by Nilfisk.

## OPERATION CAPABILITIES

The Motor scrubber-dryer is used to clean (scrubbing and drying) smooth and solid floors, in commercial or industrial environment, under safe operation conditions by a qualified operator.

## UNPACKING

To unpack the machine, carefully follow the instructions on the packing. When the machine is delivered, check that the packing and the machine were not damaged during transportation. In case of visible damages, keep the packing and have it checked by the carrier that delivered it. Call the carrier immediately to fill in a damage claim.

Please check that the following items have been supplied with the machine:

1. DRYFT
2. S-Handle
3. CORE-ion Battery
4. Battery Charger
5. Charger Cable
6. MAGPlate
7. Floor Pad
8. Quick Start Guide



### WARNING!

*Always inspect DRYFT for damage before use.*



### CAUTION!

*After unpacking, carefully assemble the machine according to the instruction sheet inside the packaging.*

## TRANSPORTING



**CAUTION:** *Disconnect the battery and secure the machine when transporting in a vehicle to prevent damage to the machine.*

DRYFT has been designed to be safe and easy to transport when following the safety rules detailed below.

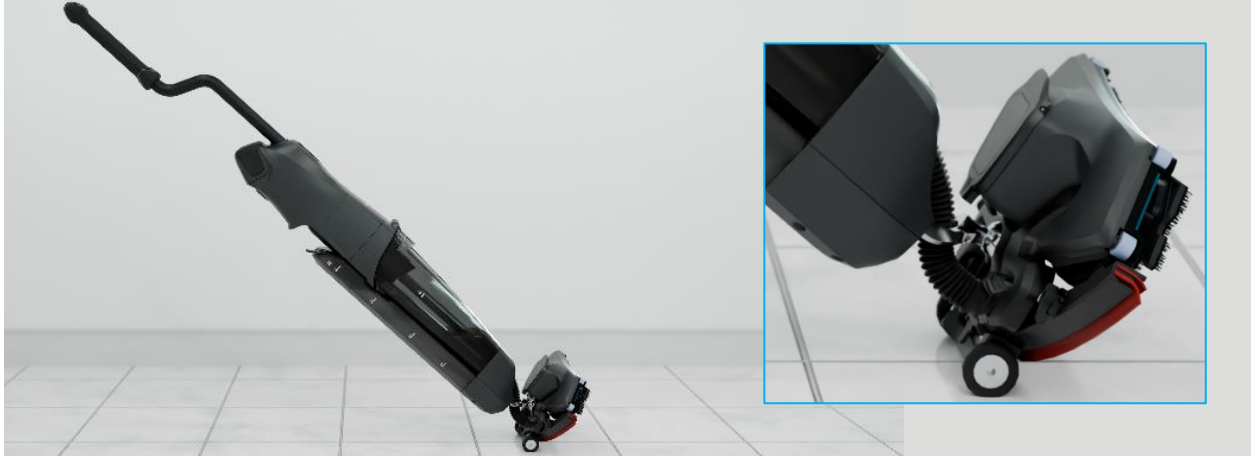

1. Place your foot on the bar at the rear between wheels and pull the handle to engage transport mode. Alternatively use your hand to lift the head



2. Now you can push the machine in your desired direction.

## SAFETY

Always read this information carefully and take all necessary precautions to safeguard people and property. The operator's cooperation is essential to prevent injury. No accident prevention program is effective without the total cooperation of the person responsible for the machine operation. Most of the accidents that may occur in a factory, while working or moving around, are caused by failure to comply with the simplest rules for exercising prudence. A careful and prudent operator is the best guarantee against accidents and is essential for successful completion of any prevention program.

We've used symbols throughout our manual to draw your attention to important safety guidance, features and information.

Below is an overview of what each warning symbol means:

### WARNING SYMBOLS



#### **DANGER!**

*Indicates an imminent dangerous situation that, unless avoided, will result in death or serious injuries.*



#### **WARNING!**

*Indicates a potentially dangerous situation that, unless avoided, could cause death or serious injury.*

**CAUTION!**

*Indicates a potentially dangerous situation that, unless avoided, could cause slight or moderate injuries.*

**INFORMATION!**

*Indicates additional information for the operator, to improve the use of the device.*

**CAUTION!**

*This machine is for indoor use only.*

**ATTENTION!**

*Do not submerge the machine into water.*

**CAUTION!**

*Please be aware of the integrated magnets that are present in the MAGPlate.*

**WARNING!**

*DRYFT's MAGPlate contains magnets. You should keep magnets and the MAGPlate 6 inches (15cm) away from implanted medical devices.*

**SAFETY BASICS**

DRYFT is incredibly safe and easy to use. However, as it is an electrical product we need to make you aware of some important safety information. By following the advice on this page, you can reduce any risk of electric shock and personal injury.

**DANGER!**

*Do not operate in the presence of explosives, or flammable fumes or liquids. Ensure any chemicals you use are non-flammable.*

**DANGER!**

*DRYFT is powered by DC current only. Do not attempt to operate DRYFT with AC current.*

**DANGER!**

*Never attempt to operate DRYFT from an electrical outlet. It should only be powered by the DRYFT CORE-ion 25.2-volt battery.*

**DANGER!**

*Consider your work area environment when using DRYFT.*

**WARNING!**

*When changing accessories or undertaking maintenance on DRYFT, you should always disconnect the battery from the machine.*

**CAUTION!**

*DRYFT is a power tool. Although it is safe to operate with one hand during operation, you should operate with both hands when switching the machine on and off.*



*DRYFT is designed to be used by experienced and knowledgeable cleaning professionals over the age of 18. It must not be used by children or anyone with a physical, mental or sensory impairment which could make using DRYFT unsafe.*



*Your DRYFT must be kept clean to ensure safe operation. The upper handle and switch area should be dry, and the machine should be clean and free from oil, grease and water when not in use. Always flush out chemical with clean water after every use.*



*Always follow instructions for attaching accessories.*



*Keep charger cords and wires away from heat, oil and sharp edges.*



*Ensure you adopt the correct posture when using DRYFT.*



**WARNING!**

*All operators should be adequately instructed on the use of this machine.*



**WARNING!**

*Do not use for cleaning purposes on surfaces having a gradient exceeding that marked on the machine.*

**OTHER SYMBOLS EXPLAINED**



**Open book symbol with an "i"**

*Indicates the need to consult the instruction manual.*



**Open book symbol**

*Tells the operator to read the user manual before using the device.*



**Wear Safety Footwear:**

*To signify that safety footwear must be worn.*



**Wear Protective Gloves:**

*To signify that protective gloves must be worn.*



**Wear Eye Protection:**

*To signify that eye protection must be worn.*



**Magnetic Field Symbol:**

*To signify magnetic field.*



**This Product Contains Magnets:**

*Magnets may interfere with implanted medical devices. Users with an implanted medical device should consult with their doctor/physician to seek advice regarding risks associated with using this product.*



**Disposal Symbol:**

*Information regarding the correct means for disposing the appliance.*



**International Recycling Symbol****Ventilation:**

*Specific function should only be performed in a well-ventilated environment.*

**For Indoor Use Only:**

*To identify electrical equipment designed primarily for indoor use.*

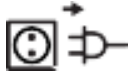
**Disconnect Power:**

*Disconnect the power between the battery and DRYFT.*

- This machine is not intended for use by persons (including children) with reduced physical, sensory or mental capabilities, or lack of experience and knowledge.
- Children should be supervised to ensure that they do not play with the appliance.
- This machine is intended for commercial use, for example in hotels, schools, hospitals, factories, shops, offices and rental businesses.
- Operators shall be adequately instructed on the use of these machines.
- This machine is for dry use only.
- This machine is for indoor use only.
- This machine shall be stored indoors only.
- The machine shall be disconnected from its power source during cleaning or maintenance and when replacing parts or converting the machine to another function:  
for battery powered machines, by safely disconnecting at least the non-frame connected pole of the battery or by an equivalent method (disconnecting device).
- Do not use on slopes.

## MACHINE DESCRIPTION

### KNOW YOUR EQUIPMENT

- ① Spin Handle
- ② S-Handle
- ③ Control Panel
- ④ DRYFT CORE-ion Battery
- ⑤ Suction Unit
- ⑥ Clean water Tank
- ⑦ Magnetic Recovery Tank
- ⑧ Transportation Wheels
- ⑨ MAGPlate
- ⑩ Quick Release Squeegee
- ⑪ Wall Protection Glide Wheels
- ⑫ Solenoid Unit



**CONTROL PANEL**

DRYFT’s simple control panel has been designed to allow the user to easily switch between smooth floor mode and rough floor mode at the press of a button

DRYFT has a stopping sequence. Suction remains on at end of cycle for three seconds, this is to help collect excess water within the cleaning pad.

To override this press ‘On/Off’ button again



Watch our video and learn more about the DRYFT control panel



**Oscillation speed**  
One light for low speed, 3500rpm.  
Two lights for high speed, 4200rpm.

**Service Indicator**  
Flashes when a component experiences a fault. The related component light above will also illuminate.

**Rough floor mode**  
Select when using DRYFT on rough or textured floors. Suction speed is set to high to dry deep into texture/grout lines.  
**1 hour runtime.**

**Water release**  
Two lights indicate higher level of water release, one light indicates lower level of water release. High level 20-minute water runtime. Eco mode 40-minute water runtime.

**Suction power**  
High speed for textured floors, low speed for smooth floors. Hold down for 5 seconds for boost mode.

**On/Off**  
Press to turn machine on and off.

**Smooth floor mode**  
Select when using DRYFT on a smooth floor, the suction will drop to low speed.  
**1 hour 15 runtimes.**

**QUICK START GUIDE**



1. Charge battery.



2. Insert handle.

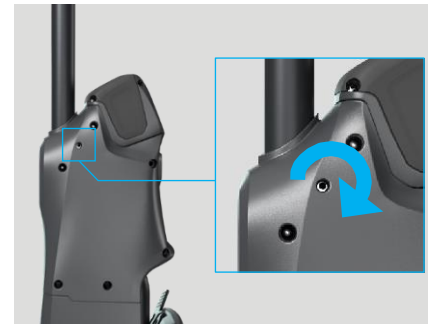

3. Tighten the handle with the allen key provided.



4. Fix floor pad to MAGPlate.



5. Fit MAGPlate to cleaning head.



6. Pull off the Clean Water Tank.

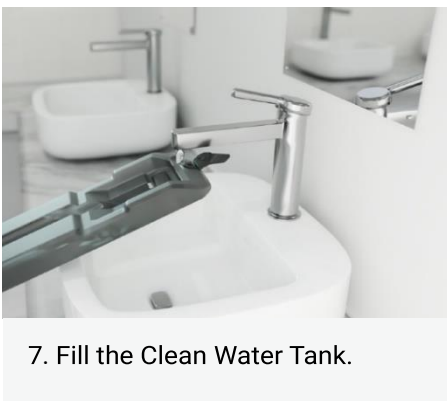

7. Fill the Clean Water Tank.



8. Check Magnetic Recovery Tank is empty.



9. Insert battery into DRYFT.

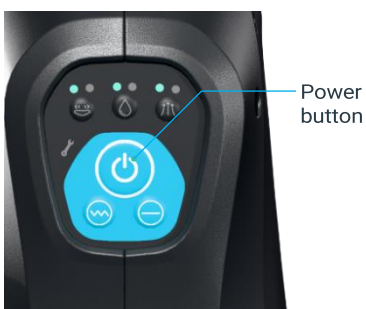

Power button

10. Press power button to turn on.



Smooth floor mode

Rough floor mode

11. Select smooth or rough floor mode.



12. Clean at DRYFT speed.

## HOW DRYFY WORKS



1. Water release channel evenly applies water to the floor.



2. Floor head scrubs at 4200rpm to lift dirt.



3. Vacuum motor and squeegees extract dirt and water.

## HOW TO USE DRYFY

Always ensure you keep the cleaning head moving forward, the head works by scrubbing and then using the squeegees to extract the dirt and water.

We recommend two methods of use:



1. Walk behind

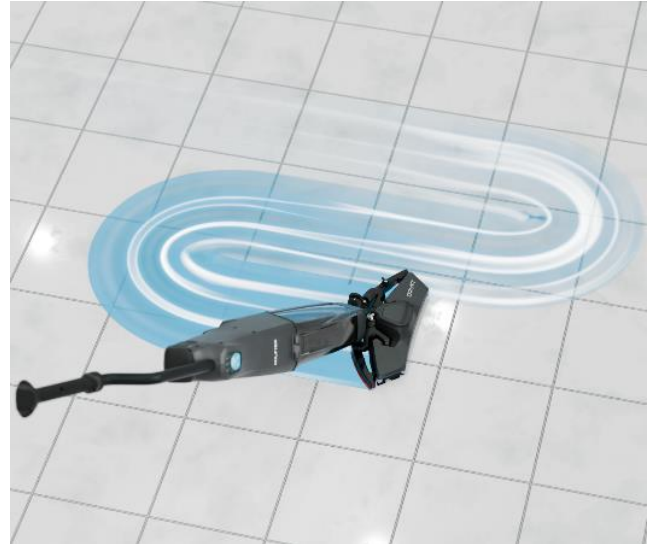

2. S-Motion

## WHERE TO USE DRYFY



Low profiles



Clean corners

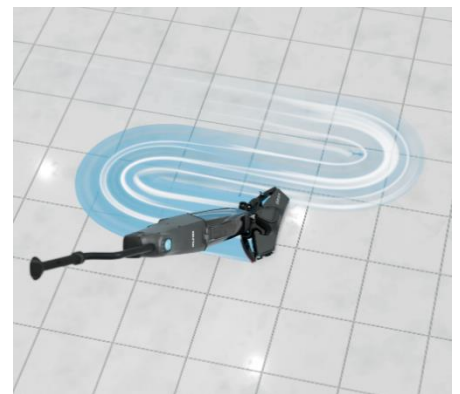

Open spaces



Under partitions



Around toilets



Hard-to-reach areas

### MAINTAINING CORRECT POSTURE

DRYFT is the world's first S-Motion Scrubber Dryer. DRYFT cleans in widths of 160cm/63" whilst you walk forward once, in comparison to other scrubbers, that require the user to walk four times up and down to cover this same cleaning width. The result is 75% less walking with DRYFT allowing the user to double their floor cleaning productivity.

Up to 160cm **scrubbing path**



### WALKING FORWARDS

This is how to hold the machine when walking forwards and is best for cleaning tight areas. We recommend using DRYFT like this in the beginning, then once you feel comfortable with the machine you can progress to the S-motion technique.



## THE WAY WE CLEAN

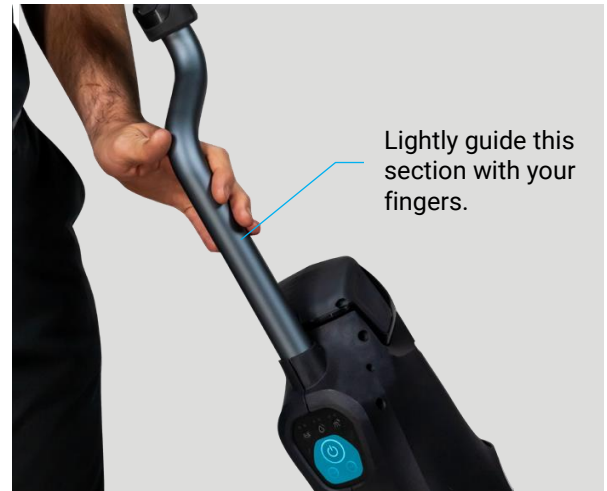
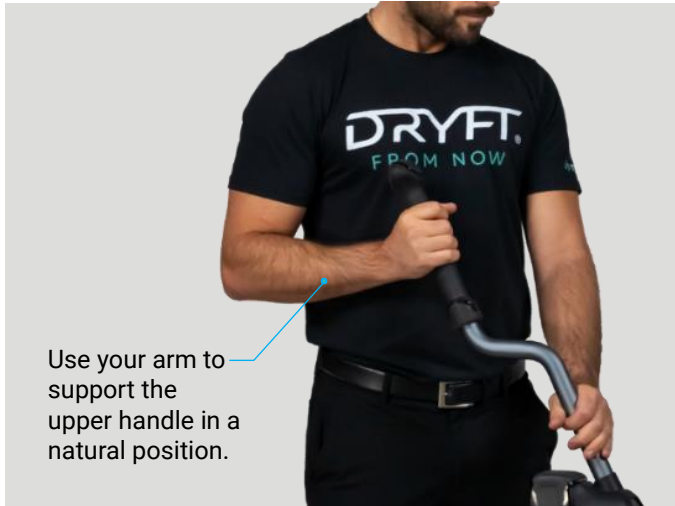

1. With your feet shoulder width apart, use your arm to support the upper handle in a natural position.
2. Lightly guide the lower handle with your fingers for fluid motion. Do not grip the lower handle tightly as this will restrict movement.

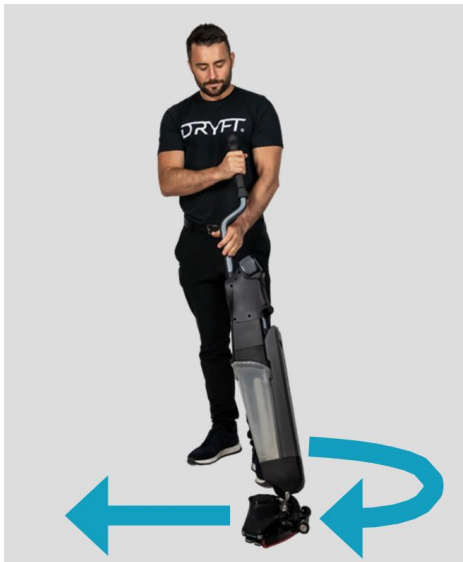

3. Turn the machine by guiding the lower handle with your fingers.

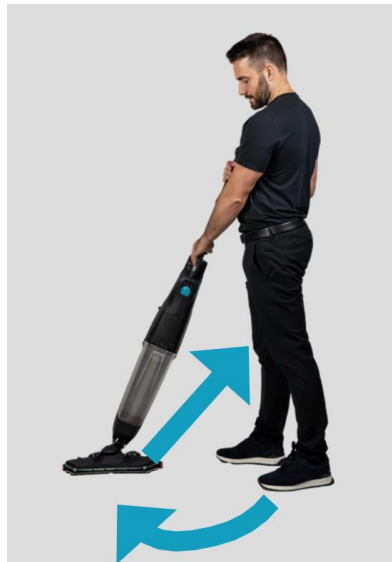

4. Push DRYFT across your body then into a wide swing.

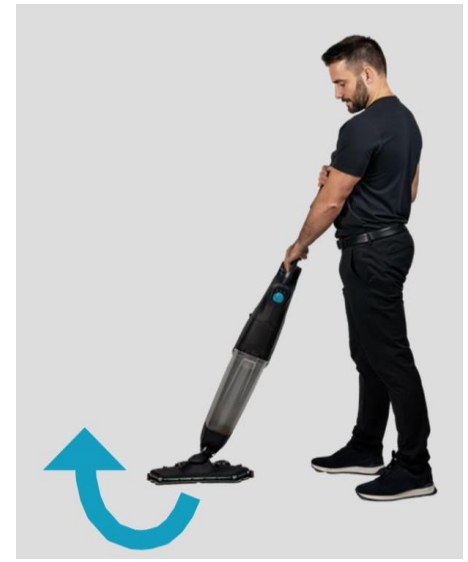

5. Guide DRYFT back across your body again, creating an S formation

Repeat these steps, this technique will soon become fluid and effortless within minutes of practice.

**TECHNICAL DATA**

<b>Model</b>	<b>NILFISK DRYFT V1</b>
Scrubbing width (mm)	390
Low profile head height (mm)	<50
Brush head oscillations high / low (rpm)	4200 / 3500
Machine voltage (V)	25.2
Battery capacity (Ah)	5
Battery running time high vacuuming (mins)	Up to 60
Battery running time low vacuuming (mins)	Up to 75
Full charge / 90% Charge (mins)	95 / 60
Solution tank size (L)	2.5
Recovery tank size (L)	2.8
Machine dimensions in working mode (L x W x H - mm)	430 x 230 x 1485
Gross weight (empty and with battery - kg)	7.3
Shipping weight with Lithium Battery (full package - kg)	10,16
Vibration level at operator's arms (m/s <sup>2</sup> )	<2,5
Sound pressure level at workstation (dBA)	<70



**WIRING DIAGRAM**

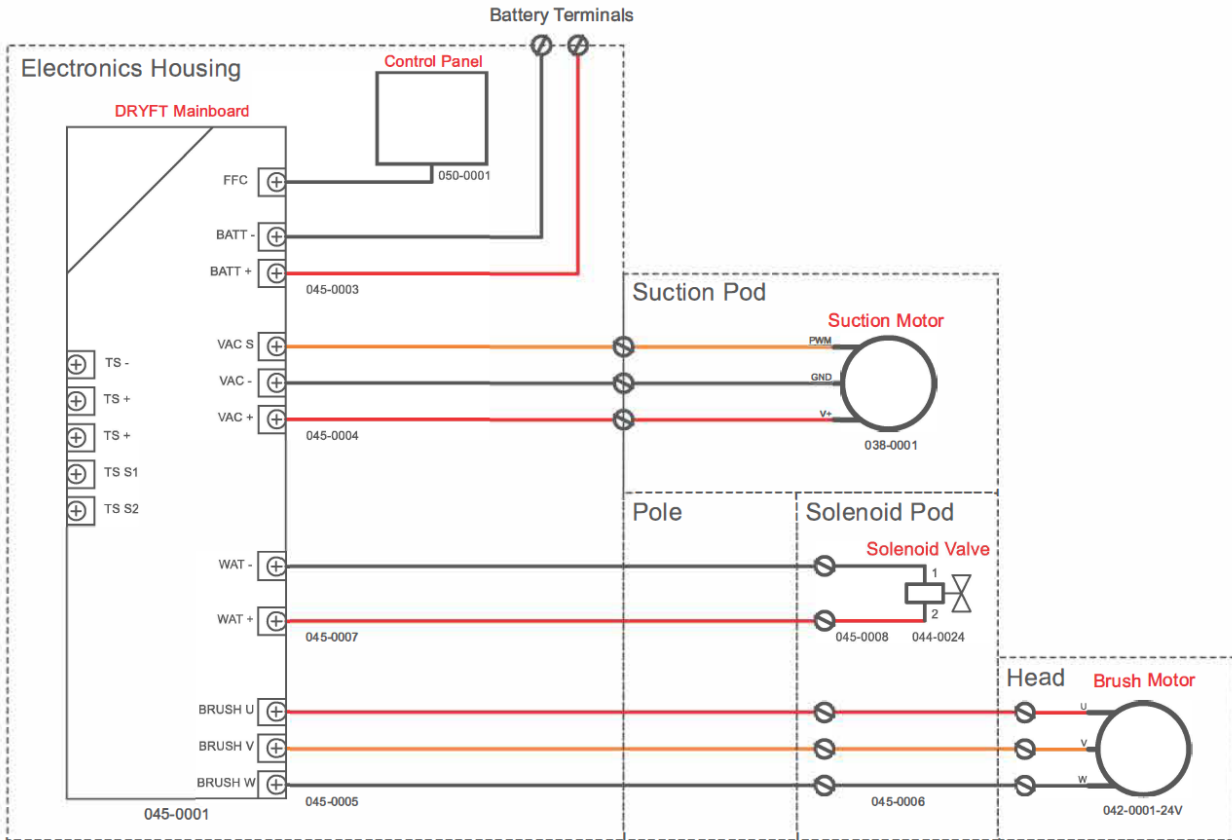

Pin Name	Description
FFC	FFC to control panel
BATT -	Battery -
BATT +	Battery +
VAC S	Vacuum Signal
VAC -	Vacuum -
VAC +	Vacuum +
WAT -	Water Solenoid -
WAT +	Water Solenoid +
BRUSH U	Brush U
BRUSH V	Brush V
BRUSH W	Brush W

## MAINTENANCE

The lifespan of the machine and its maximum operating safety are ensured by correct and regular maintenance. The following table provides the scheduled maintenance. The intervals shown may vary according to particular working conditions, which are to be defined by the person in charge of the maintenance.



### WARNING!

*The procedures must be performed with the machine off and the battery disconnected. Moreover, read carefully the instructions in the Safety chapter before performing any maintenance procedure.*

All scheduled or extraordinary maintenance procedures must be performed by qualified personnel, or by an authorized Service Center.

This Manual describes only the simplest and most common maintenance procedures. For other maintenance procedures shown in the Scheduled Maintenance Table.

## BATTERY

### ABOUT BATTERY

This manual contains all the information you need to get started with your CORE-ion battery. Please read these instructions carefully.

DRYFT is powered by the CORE-ion lithium-ion battery.

Your DRYFT CORE-ion battery is incredibly safe, it has been tested and certified to the most stringent safety standards. However, as a lithium-ion battery we need to make you aware of some important safety information.

By following the advice within this manual, you can reduce any risk of electric shock, fire and personal injury.

Only use the battery charger provided with DRYFT to ensure it is charged safely.



### SAFETY BASICS

We've used symbols throughout our manual to draw your attention to important safety guidance, features and information. Here is an overview of what each symbol means.



#### Open book symbol with an "i"

*Indicates the need to consult the instruction manual.*



#### Open book symbol

*Tells the operator to read the user manual before using the device.*



#### Disposal Symbol:

*Information regarding the correct means for disposing the appliance.*



#### Wear Protective Gloves:

*To signify that protective gloves must be worn.*



#### Wear Eye Protection:

*To signify that eye protection must be worn.*



**DANGER:** *Do not disassemble, heat above 140f (50c) or incinerate the battery. Risk of fire, explosion, or burns.*



**WARNING:** *Never attempt to open a battery for any reason. If the housing of the battery breaks or cracks, immediately discontinue use and do not recharge. The battery should be replaced.*



**CAUTION:** Remove ALL metallic objects from the person when working with batteries. This includes jewelry (rings, bracelets, necklaces), watches, pens, torches, etc.



**WARNING:** Where there are signs of damage or liquid (electrolyte) or solid deposits, rubber gloves and acid-resistant clothing must be worn when handling the batteries and affected packaging to protect against the effects of any electrolyte that may be present.



**WARNING:** Do not submerge the battery into water.



**CAUTION:** Do not submerge the battery into water.



**CAUTION:** This battery is for indoor use only.



**CAUTION:** If it is suspected that free electrolyte is present, then safety glasses must be worn, and if large amounts are present, chemical goggles or a face shield should be used.



**CAUTION:** In the unlikely event of battery leakage wash eyes and skin with water if contact is made with acid.

## BATTERY INDICATION LIGHTS

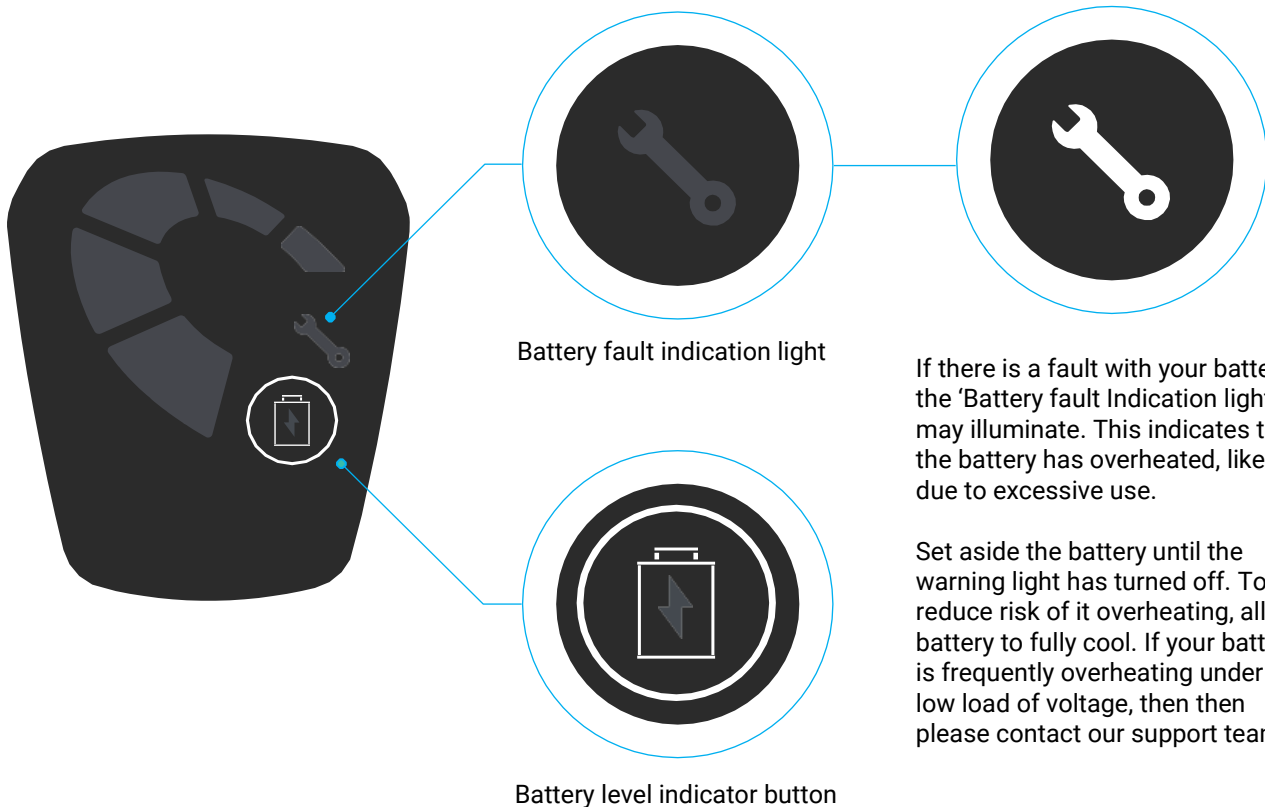

## BATTERY LEVEL DISPLAY

When using DRYFT, the CORE-ion Battery level display will show in 20% increments. Likewise, when charging the CORE-ion Battery, the battery level display will flash the current state of charge in 20% increments.

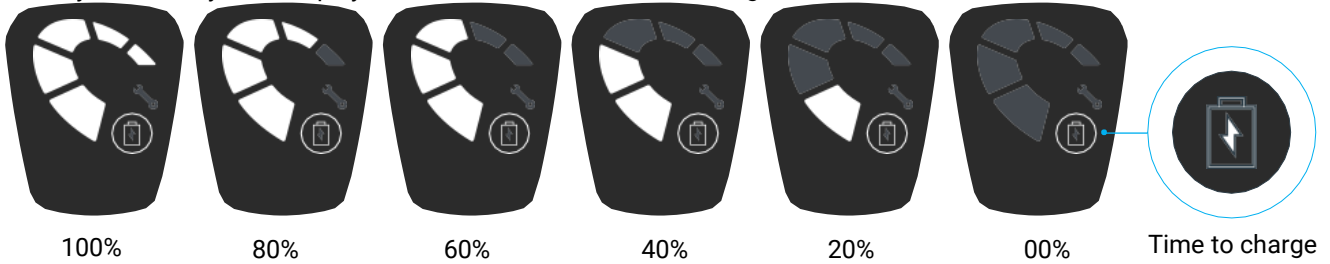

When the battery is placed in the battery charger, or in a machine the state of charge will display automatically.

## BATTERY HEALTH

The CORE-ion battery's health and longevity are monitored using a rolling average calculated over a year of typical usage. This approach ensures consistent performance insights and helps you track expected battery performance.

For typical usage, the battery is anticipated to undergo approximately 260 full charging cycles per year - equivalent to a full recharge five days a week.

Under these conditions, a gradual decrease in power capacity is expected. After one year of typical usage, battery capacity is estimated to reduce by approximately 10%, which will impact the runtime of your DRYFT machine. Specifically:



### Smooth Floor Mode:

*Initial runtime of up to 75 minutes will decrease to approximately 67 minutes.*



### Rough Floor Mode:

*Initial runtime of up to 60 minutes will decrease to approximately 54 minutes.*

This progressive change is normal for lithium-ion batteries, reflecting the natural wear of high-efficiency power cells.

## CHARGING YOUR DRYFT BATTERY

Your CORE-ion battery code 005-0011/005- 0024 is a rechargeable Lithium-ion battery to be charged only with the (005-0012) FY2945000 Core-ion battery charger.

Always plug your charger directly into a 120 VAC/60HZ or 240 VAC electrical outlet or use an adapter or charger for the AC source being used (do not use an extension).

Batteries should be charged before using your DRYFT, after each use and if unused for four months. A full charge from flat will take approximately 60 minutes. With a fully charged battery, the machine will run for up to 60 to 75 minutes, depending on cleaning mode selected. Different floor and pad types may reduce run time.

If you require long periods of machine use, we recommend you also order spare batteries.



For best results, do not charge a battery when the battery or air temperature is below 40°F (5°C) or above 105°F (40°C).

When charging the CORE-ion Battery, the green light will show, when the battery is fully charged the light will turn red. After charging, disconnect the charger from the AC outlet and (IMPORTANT) disconnect the charger from the battery.



**WARNING:** Do not charge a battery if it is wet or shows any evidence of corrosion.



**WARNING:** Plug the battery charger directly into a 120VAC/60HZ or 240VAC electrical outlet, with the correct plug adaptor. (Do not use an extension cord).



**WARNING:** Only use the battery charger (005-0012) FY2945000 provided with this appliance to charge the CORE-ion battery (005-0011 / 005-0024).



**WARNING:** Do not charge the CORE-ion battery in environments above 50°C, discharge or store above 122°F (50 °C).



**ATTENTION:** The space used for charging the battery must be adequately ventilated.

## CLEAN WATER TANK

### CLEANING



1. Lift tank vertically, before pulling away from the DRYFT.



2. 2.5 liter/0.55 gallon capacity, do not fill above the fill limit indicator.



3. Ensure the tank is hooked on properly and pushed down fully to engage the valve.

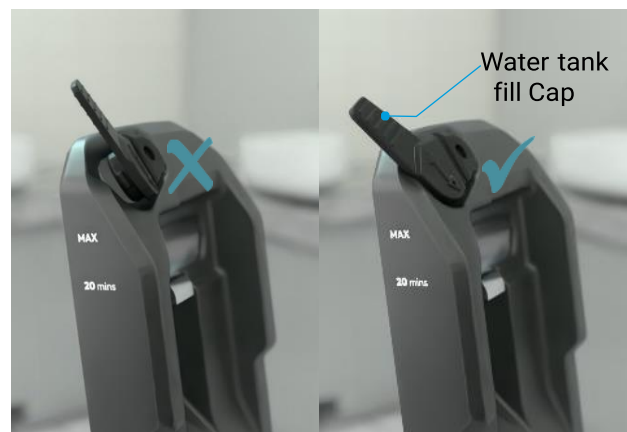

4. Always ensure water cap is in place and fully secured.



Valve assembly

5. Ensure the valve at bottom of tank is free from debris.

### PREPARING CLEANING SOLUTION

DRYFTs powerful agitation and latest pad technology will clean floors using just water. Some cleaning challenges may require chemicals. For example, use a degreaser for removing grease or oil, and use a de-scaler for removing scale build up in bathrooms.



Fill the clean water tank with your preferred cleaning solution, ensure to seek chemical manufacturers advice on dilution ratio.



Do not fill above max fill line.

It is very difficult for us to approve every chemical on the market, however the majority of cleaning detergents are safe to use with DRYFT. It is important that the chemicals must be low foaming and machine safe. High foaming chemicals can damage your vacuum motor and void the warranty on the motor. It is possible that the life expectancy of some components will be reduced, such as the water tank valve, solenoid valve, water release outlets, suction hose and other components which come into contact with the chemical. These components are all replaceable at affordable costs. Using some harsh chemicals may result in more frequent servicing.



**WARNING:** *Ensure current regulations concerning safe transportation of dangerous substances are followed.*



**WARNING:** *Do not use flammable chemicals or solutions.*

## MAGNETIC RECOVERY TANK

The DRYFT recovery tank has a clear 'max' fill marker located on the tank, in normal usage (non-spill recovery) the recovery tank will become full at a similar time to the solution tank requiring a refill, so we recommend that you complete these tasks in parallel. IF you do overfill the recovery tank there will be clear visual & audible feedback (water leakage) from the suction motor exhaust area. You should stop using the machine immediately. The suction motor is designed to withstand some water ingress, but repeated misuse could reduce component performance & life.

### CLEANING

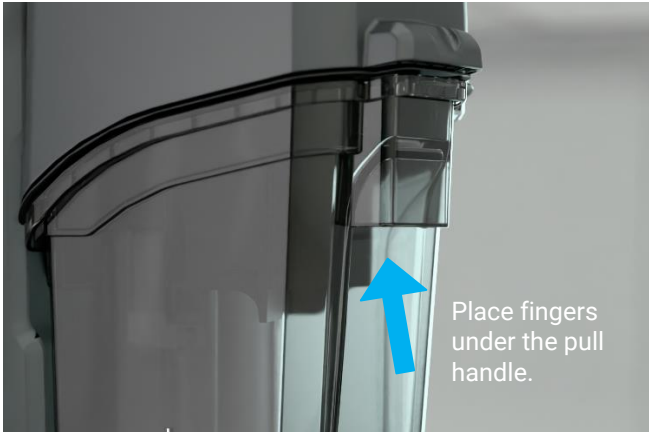

1. To remove the Magnetic Recovery tank, pull on the handle in an upward position away from the center pole.



2. Pull the tank away from the lower housing.



3. Holding the tank with two hands, empty the recovery liquid appropriately



4. We advise cleaning the tank with a bottle brush and warm soapy water.



5. Ensure upper seal of the 'tank lid' is secure, undamaged and free from debris.



6. Place the bottom of the tank into the lower housing as shown, then push the tank towards the pole, so that it locks into place.



**WARNING:** *Ensure chemical waste is disposed correctly per chemical producers' instruction and advice.*



**WARNING:** *Do not use flammable chemicals or solutions.*

### INLET FILTER SERVICE AND REPAIRS

Ensure the inlet filter is always kept clean and secured in place before using DRYFT.

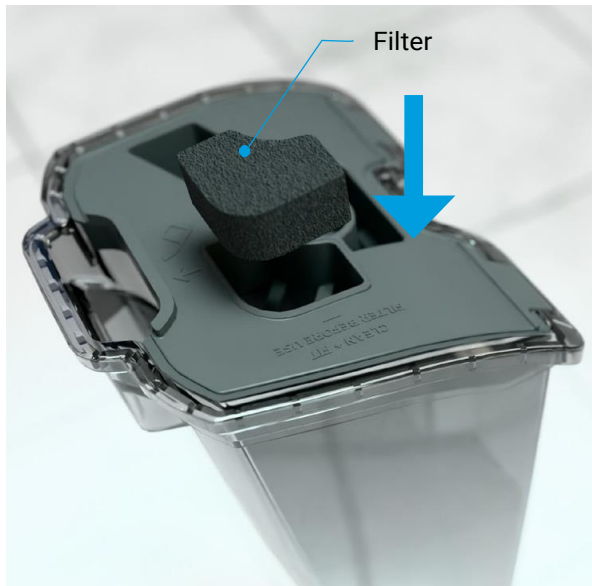

Check the filter before each use and clean as required. If the filter is left to become clogged this will reduce airflow resulting in poor drying performance.

### MAGPLATE AND PADS

The DRYFT MAGPlate magnetic pad holder system has been designed to allow for quick and hygienic pad replacements between cleaning areas.

Whilst our magnets are not deemed 'strong', some precautions should be taken to reduce all risks.

Keep magnetic media such as computer disks, credit cards, mobile phones away from the magnets.



**WARNING:** *ALWAYS remove the CORE-ion battery from DRYFT before adding or removing the MAGPlate or cleaning pads.*



**WARNING:** *DRYFT's MAGPlate contains magnets. You should keep magnets and the MAGPlate 6 inches (15cm) away from implanted medical devices.*





**WARNING:** *Ensure fingers are kept clear of DRYFT's oscillating mechanism.*



**CAUTION:** *Be cautious of the MAGPlate suddenly 'snapping' to the DRYFT head whilst installing.*



**WARNING:** *Using third party floor pads can cause the oscillating mechanism to become unbalanced causing excessive vibration and possible damage to the machine. Ensure only official DRYFT pads are used to avoid invalidating your warranty.*

## PADS AND APPLICATIONS

DRYFT is supplied with one cleaning pad it is non-scratch, washable and suitable for cleaning all hard floors, smooth and textured

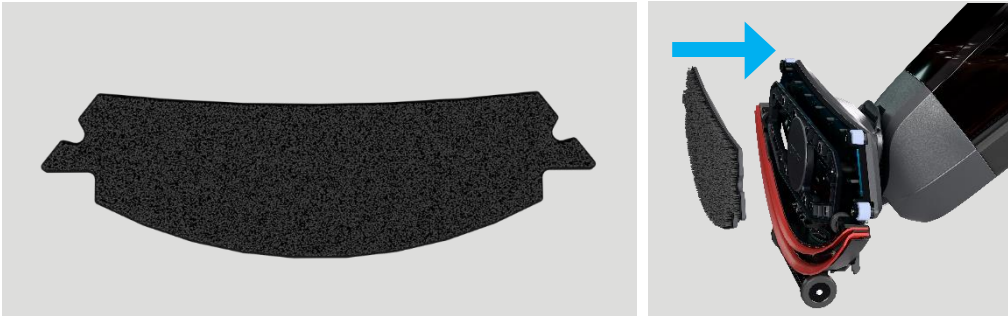

Designed specifically for DRYFT, this revolutionary material has been designed to maximize DRYFT's groundbreaking oscillating technology. Made up of thousands of fibers, each one is angled to gently agitate and remove dirt from smooth and textured floors.

Application: Versatile pad suitable for cleaning all floor types.

Reusable: This pad should last three to six months of daily use.

## PAD CLEANING

1. Remove MAGPlate.
2. Peel cleaning pad from the MAGPlate.
3. For disposable pads - disclose in accordance with local environmental regulations.
4. Washable pads can be cleaned using the instructions provided on the pad labelling.



**CAUTION:** *Only use cleaning pads which have been specifically designed and recommended for DRYFT. We cannot guarantee the safety of any other cleaning pads.*

## CHANGING YOUR MAGPLATES AND PADS

**IMPORTANT!** Remove the CORE-ion battery before you do the following:



1. Flip the head into the transport position



2. Pull MAGPlate from the bottom,

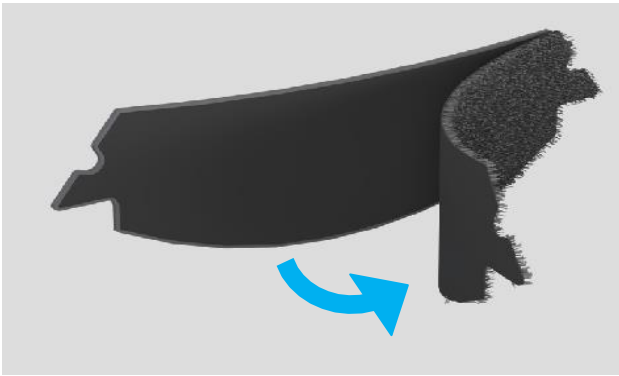

3. Gently peel off the cleaning pad from the hook and loop finish.



4. Place cleaning pad onto the floor and align the MAGPlate so that it is perfectly central.



5. Attach MAGPlate onto the base of DRYFT, ensuring fingers are kept clear. MAGPlate will magnetically lock into place.



6. Lower DRYFT head onto the floor into cleaning position.

**SQUEEGEE**

Quick release squeegee:

The function of the squeegee is to collect dirty water from the floor surface and optimize water recovery. Four tool-free twist locks enable the squeegee to be quickly released for cleaning or a swift replacement.

Checking squeegee wear:

If drying performance is reducing over time then it might be due to squeegee wear. We recommend removing the squeegee and checking for damage and wear.



**HOW TO REMOVE THE SQUEEGEE**

IMPORTANT! Remove the CORE-ion battery before you do the following:

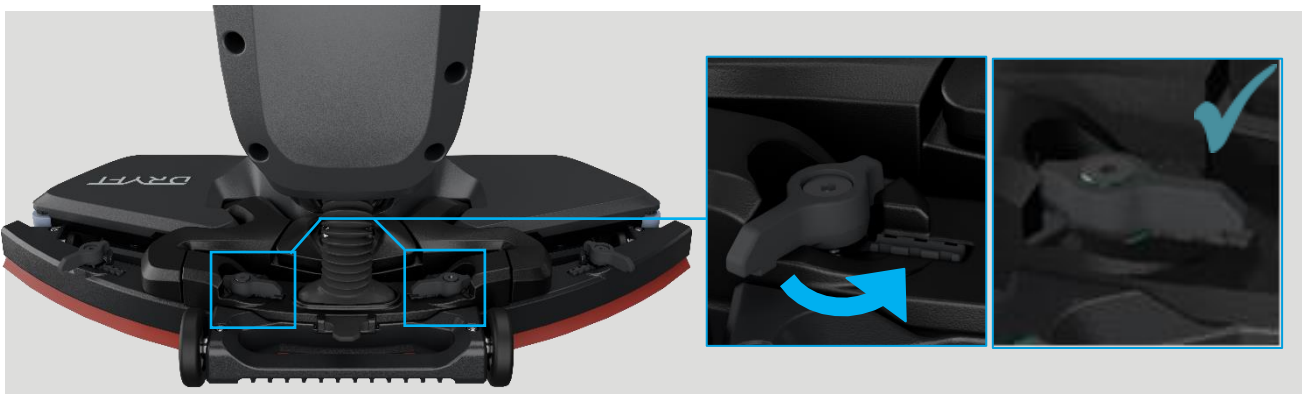

1. Turn the central twist locks first.



2. Press down on the two inner wing-nuts with your thumbs to release the squeegee bar from the bracket.



3. Drop out the inner squeegee.

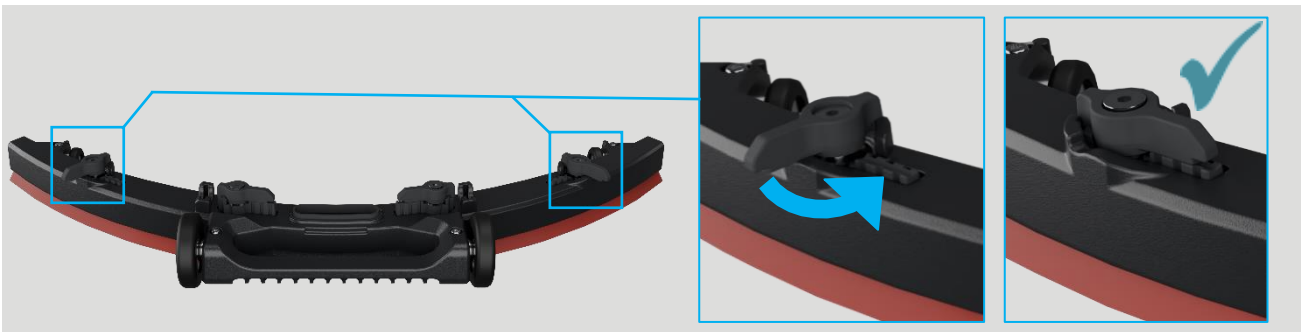

4. Place the squeegee on a flat surface and twist the two remaining twist locks.



5. Gently pull the squeegee away from the retaining hooks.

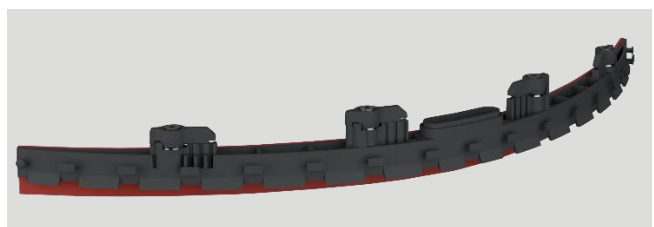

6. The bracket is now accessible for cleaning or replacement squeegee.

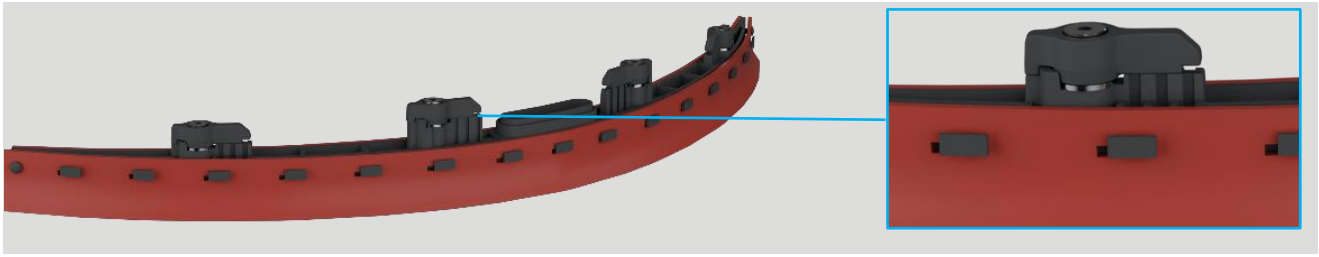

7. Ensure the squeegee is hooked on evenly on each hook before reinstating.

To reinstate the squeegee: Reverse these steps in order to reinstate the squeegee back in place.



#### NOTE

*The squeegee must be clean, and its blades must be in good conditions to get a good drying.*



#### WARNING!

*It is advisable to wear protective gloves when cleaning the squeegee because there may be sharp debris*

#### CLEANING WITH DRYFT

When using the machine:

When using DRYFT make sure the pad is flat to the floor, this will ensure smooth operation of the machine and an optimal clean.

Water usage:

DRYFT is a low water use cleaning machine. Only a small amount of water or detergent is needed to wet and clean the floor. Simply allow the pad and powerful oscillating action to release the dirt.

After every use:

After every use, you need to empty the clean water tank and recovery tanks. This will reduce the risk of spillage, but also reduces the risk of bad odor due to bacteria build up.

Magnetic media:

Keep magnetic media such as computer disks, credit cards, mobile phones away from the magnets.

Do not use water hotter than 35°C (95°F), this can damage the valve.



**ATTENTION:** Do not submerge DRYFT into water.



**SLIP HAZARD:** DRYFT applies water and/or cleaning solution to the floor. Whilst the DRYFT recovers the majority of the fluid there is still potential for a slip hazard due to residual fluid. Ensure appropriate PPE footwear is worn.



**SLIP HAZARD:** DRYFT is intended for commercial use. Ensure others are alerted to the potential slip hazard by using appropriate signage.

## STORING THE MACHINE

DRYFT's compact design means that it is easy to store. When storing DRYFT, you should follow the below guidance:



1. When storing, ensure the recovery tank and the clean water tank have been emptied and the battery removed, prior to transport.



2. Remove the battery from the machine, Remove the battery from the machine,



3. Stand DRYFT up using our unique head stand design. Simply press the pedal to stand DRYFT upright and ensure the magnet catch latches into place.



***If the appliance is to be stored and unused for a long period, the battery should be disconnected from the machine. The CORE-ion battery should be removed from the DRYFT once cleaning task has been completed.***



***WARNING: When storing or carrying batteries, always ensure that they cannot come into contact with any metal objects. This could result in the battery short circuiting, causing fire, personal injury or damage to the battery.***



***WARNING: The battery and charger must never be used or stored in an outdoor environment, or in damp conditions.***



***CAUTION: This machine should be stored indoors only.***

**SCHEDULED MAINTENANCE TABLE**



Replacement instruction available by animated video:



Procedure	Daily, after using the machine	Weekly	Every six months	Yearly
Battery Charging				
Squeegee Cleaning				
Pad cleaning & wear check				
Recovery tank empty & cleaning				
Squeegee blade wear check				
Solution filter cleaning & check				
Squeegee blade replacement				
Pad holder replacement				
Brush motor check				(*)
Brush deck vibration-damper check				(*)
Vac motor check				(*)

(\*) Maintenance procedure must be performed by an authorized Nilfisk Service Center.

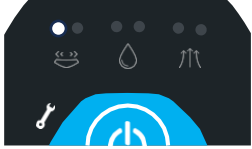
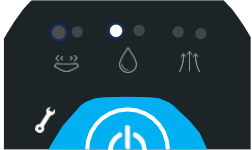
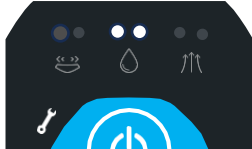
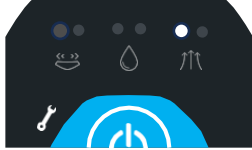
**TROUBLESHOOTING**

	Scenario	Feedback	Visual
<b>Battery</b>	<b>Low battery</b>	<b>CORE-ion:</b> Lower segment flashes for 10 seconds	
<b>Brush Motor</b>	<b>Motor doesn't start</b> (Brush motor, IC feedback) / Lock is detected (likely jammed)	<b>DRYFT:</b> - Brush motor (1 LED) - Fault detection LED (Flashing illumination)	
<b>Solenoid</b>	<b>Under current</b> (Not connected, or dead)	<b>DRYFT:</b> -Solenoid (1 LED) -Fault detection LED	
	<b>Over current</b> (Jammed, shorted)	<b>DRYFT:</b> -Solenoid (2 LED) -Fault detection LED	
<b>Suction Motor</b>	<b>Under current</b> (Not connected, or dead)	<b>DRYFT:</b> -Suction Motor (1 LED) -Fault detection LED (Flashing illumination)	
	<b>Over current</b> (Jammed, shorted)	<b>DRYFT:</b> -Suction Motor (2 LED) -Fault detection LED (Flashing illumination)	

## SCRAPPING

Have the machine scrapped by a qualified scrapper.

Before scrapping the machine, remove and separate the following materials, which must be disposed of properly according to the Law in force:

- Batteries
- Brushes
- Plastic hoses and components
- Electrical and electronic components (\*)

(\*) Refer to the nearest Nilfisk Center especially when scrapping electrical and electronic components.

## Machine material composition and recyclability data

99.94% of machine accepted for recycling

71.60% of machine likely to be recycled (\*based on 2024 recyclable efficiency percentage rates)

Type	Recyclable Efficiency % (Industry estimates [§] as of 2024)	% Weight of DRYFT	% Weight of DRYFT x Recyclable Efficiency %
Aluminum	100%	14.25%	14.25%
Steel	100%	6.09%	6.09%
Plastic (Recyclable)	70%	38.66%	27.07%
Plastic (Non-recyclable)	0%	0%	0%
Plastic Hoses	0%	0%	0%
Rubber	50%	5.88%	2.94%
Magnet	60%	2.27%	1.36%
Mixed Material Recycling	60%	2.63%	1.58%
Electrical / Electronic	50%	19.36%	9.68%
Batteries	80%	8.76%	7.01%
Wiring Harness	80%	2.03%	1.63%

[§] Recyclable efficiency percentages figures are based on general industry knowledge and reports from major recycling organizations, government agencies, and industry-specific publications as of 2024.

For precise and up-to-date information, specific reports or data from local recycling programs and waste management companies should be consulted via AI search platform.

Local variations may differ significantly, so we would recommend end users consult with their local authorities.



**HEAD QUARTER****DENMARK**

Nilfisk A/S  
Tel.: (+45) 4323 8100  
www.nilfisk.com

**SALES COMPANIES****ARGENTINA**

Nilfisk Argentina  
Tel.: (+54) 11 6091 1576  
www.nilfisk.com.ar

**AUSTRALIA**

Nilfisk Pty Ltd  
Tel.: (+61) 2 98348100  
www.nilfisk.com.au

**AUSTRIA**

Nilfisk GmbH  
Tel.: (+43) 662 456 400 90  
www.nilfisk.at

**BELGIUM**

Nilfisk n.v-s.a.  
Tel.: (+32) 24 67 60 50  
www.nilfisk.be

**BRAZIL**

Nilfisk do Brasil  
Tel.: (+11) 3959-0300 / 3945-4744  
www.nilfisk.com.br

**CANADA**

Nilfisk Canada Company  
Tel.: (+1) 800-668-8400  
www.nilfisk.ca

**CHILE**

Nilfisk S.A. (Comercial KCS Ltda)  
Tel.: (+56) 2684 5000  
www.nilfisk.cl

**CHINA**

Nilfisk  
Tel.: (+86) 21 3323 2000  
www.nilfisk.cn

**CZECH REPUBLIC**

Nilfisk s.r.o.  
Tel.: (+420) 244 090 912  
www.nilfisk.cz

**DENMARK**

Nilfisk Danmark A/S  
Tel.: 72 18 21 20  
www.nilfisk.dk

**FINLAND**

Nilfisk Oy Ab  
Tel.: (+358) 207 890 600  
www.nilfisk.fi

**FRANCE**

Nilfisk SAS  
Tel.: (+33) 169 59 87 00  
www.nilfisk.fr

**GERMANY**

Nilfisk GmbH  
Tel.: (+49) (0)7306/72-444  
www.nilfisk.de

**GREECE**

Nilfisk A.E.  
Tel.: (30) 210 9119 600  
www.nilfisk.gr

**HOLLAND**

Nilfisk B.V.  
Tel.: (+31) 036 5460760  
www.nilfisk.nl

**HONG KONG**

Nilfisk Ltd.  
Tel.: (+852) 2427 5951  
www.nilfisk.com

**HUNGARY**

Nilfisk Kft.  
Tel.: (+36) 24 475 550  
www.nilfisk.hu

**INDIA**

Nilfisk India Limited  
Tel.: (+91) 22 6118 8188  
www.nilfisk.in

**IRELAND**

Nilfisk  
Tel.: (+35) 3 12 94 38 38  
www.nilfisk.ie

**ITALY**

Nilfisk SpA  
Tel.: (+39) (0) 377 414021  
www.nilfisk.it

**JAPAN**

Nilfisk Inc.  
Tel.: (+81) 45548 2571  
www.nilfisk.com

**MALAYSIA**

Nilfisk Sdn Bhd  
Tel.: (60) 3603 627 43 120  
www.nilfisk.com

**MEXICO**

Nilfisk de Mexico, S. de R.L. de C.V.  
Tel.: (+52) (442) 427 77 00  
www.nilfisk.com

**NEW ZEALAND**

Nilfisk Limited  
Tel.: (+64) 9 414 1996  
www.nilfisk.com

**NORWAY**

Nilfisk AS  
Tel.: (+47) 22 75 17 80  
www.nilfisk.no

**PERU**

Nilfisk S.A.C.  
Tel.: (511) 435-6840  
www.nilfisk.com

**POLAND**

Nilfisk Sp. Z.O.O.  
Tel.: (+48) 22 738 3750  
www.nilfisk.pl

**PORTUGAL**

Nilfisk Lda.  
Tel.: (+351) 21 911 2670  
www.nilfisk.pt

**SINGAPORE**

Den-Sin  
Tel.: (+65) 6268 1006  
www.densin.com

**SLOVAKIA**

Nilfisk s.r.o.  
Tel.: (+421) 910 222 928  
www.nilfisk.sk

**SOUTH AFRICA**

Nilfisk (Pty) Ltd  
Tel.: +27118014600  
www.nilfisk.co.za

**SOUTH KOREA**

Nilfisk Korea  
Tel.: (+ 82) 2 3474 4141  
www.nilfisk.co.kr

**SPAIN**

Nilfisk S.A.  
Tel.: (34) 93 741 2400  
www.nilfisk.es

**SWEDEN**

Nilfisk AB  
Tel.: (+46) 31 706 73 00  
www.nilfisk.se

**SWITZERLAND**

Nilfisk AG  
Tel.: (+41) 71 92 38 444  
www.nilfisk.ch

**TAIWAN**

Nilfisk Ltd  
Tel.: (+88) 6227 00 22 68  
www.nilfisk.tw

**THAILAND**

Nilfisk Co. Ltd.  
Tel.: (+66) 2275 5630  
www.nilfisk.co.th

**TURKEY**

Nilfisk A.S.  
Tel.: +90 216 466 94 94  
www.nilfisk.com.tr

**UNITED ARAB EMIRATES**

Nilfisk Middle East Branch  
Tel.: (+971) (0) 655-78813  
www.nilfisk.com

**UNITED KINGDOM**

Nilfisk Ltd.  
Tel.: (+44) (0) 1768 868995  
www.nilfisk.co.uk

**UNITED STATES**

Nilfisk, Inc.  
Tel.: (+1) 800-989-2235  
www.nilfisk.com

**VIETNAM**

Nilfisk Vietnam  
Tel.: (+84) 761 5642  
www.nilfisk.com

# NILFISK