

QUICK START GUIDE

SW3000

559506139 A (02.2025)

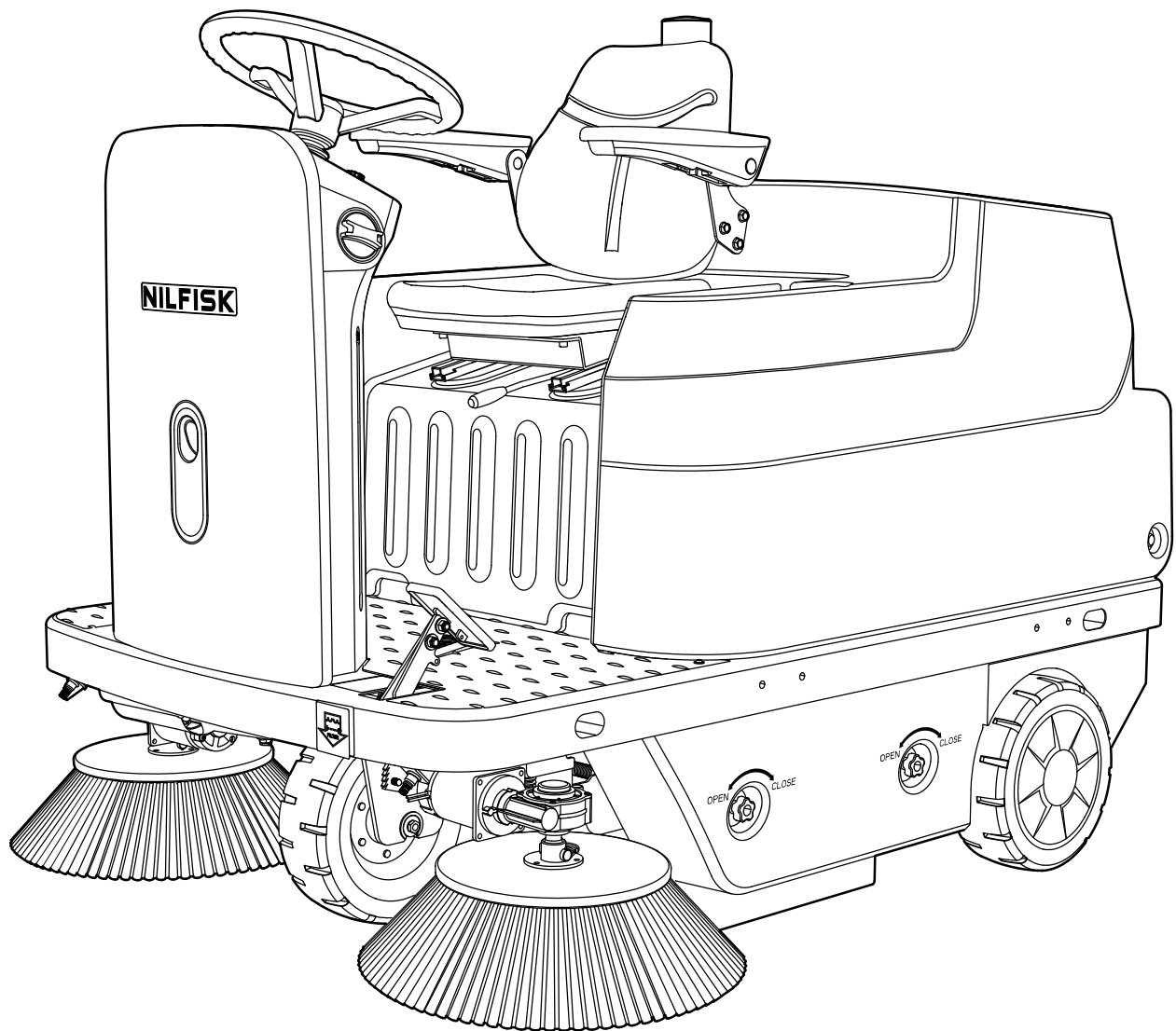

Model No.:
500000740, 50000742



NILFISK

NILFISK

EU / UE / EL / EC / EE / ES / EÜ / AB / EG

Declaration of Conformity

Prohlášení o shodě
Konformitätserklärung
Overensstemmelseserklæring
Declaración de conformidad
Vastavusdeklaratsioon
Déclaration de conformité
Vaatumustenmukaisuusvakuutus

Декларация за съответствие

Δήλωση συμμόρφωσης
Megfelelősségi nyilatkozat
Izjava o skladnosti
Dichiarazione di conformità
Atitikties deklaracija
Atbilstības deklarācija
Samsvarserklæring

Conformiteitsverklaring

Declaração de conformidade
Deklaracja zgodności
Declaratie de conformitate
Försäkran om överensstämmelse
Vyhlasenie o zhode
Izjava o skladnosti
Uygunluk beyanı

Manufacturer / Výrobce / Hersteller / Fabrikant / Fabricante / Κατασκευαστής /
Gyártó / Proizvođač / Fabbicante / Gamintojas / Ražotājs / Producent /
Fabrikant / Fabricante / Producent / Producător / Tillverkaren / Výrobca /
Proizvajalec / Üretici firma:

**Nilfisk A/S, Marmorvej 8
DK-2100 Copenhagen Ø, DENMARK**

Product / Produkt / Producto, Toode, Produit, Tuote / Προϊόν
/ Termék / Proizvod / Prodotto / Produkts / Produkts /
Artikel / Produtos / Produs / Izdelek / Ürün

SW3000

Description / Popis / Beschreibung / Beskrivelse / Descripción /
Kirjeldus / La description / Kuvaus / Описание / Περιγραφή / Leirás /
Opis / Descrizione / Aprašymas / Apraksts / Beschrijving / Descrição /
Descriere / Beskrivning / Popis / Açıklama

**FC - Floor Scrubber/Sweeper - Battery
Charging mode: 220-240V 50-60Hz,
Working mode: 24V DC, IP24**

EN We, Nilfisk hereby declare under our sole responsibility, that the above-mentioned product(s) is/are in conformity with the following directives and standards.

BG Ние, Nilfisk C настоящото декларираме на своя лична отговорност, че посочените по-горе продуктът е в съответствие със следните директиви и стандарти.

NL We verklaren Nilfisk hierbij op eigen verantwoordelijkheid, dat het bovengenoemde product voldoet aan de volgende richtlijnen en normen

CS My, Nilfisk prohlašujeme na svou výlučnou odpovědnost, že výše uvedený výrobek je ve shodě s následujícími směnicemi a normami.

EL Εμείς, Nilfisk δηλώνουμε με αποκλειστική μας ευθύνη, ότι το προαναφερόμενο προϊόν συμμορφώνεται με τις ακόλουθες οδηγίες και πρότυπα.

PT Nós, a Nilfisk declaramos, sob nossa exclusiva responsabilidade, que o produto acima mencionado está em conformidade com as diretrizes e normas a seguir.

DE Wir, Nilfisk erklären in alleiniger Verantwortung, dass das oben genannte Produkt den folgenden Richtlinien und Normen entspricht.

HU Mi, Nilfisk kijelentjük, egyedüli felelősséggel, hogy a fent említett termék megfelel az alábbi irányelveknek és szabványoknak

PL My, Nilfisk Niniejszym oświadczamy z pełną odpowiedzialnością, że wyżej wymieniony produkt jest zgodny z następującymi dyrektywami i normami..

DA Vi, Nilfisk erklærer hermed under eget ansvar at ovennævnte produkt(er) er i overensstemmelse med følgende direktiver og standarder.

HR Mi, Nilfisk izjavljujemo pod punom odgovornošću, da gore navedeni proizvod u skladu sa sljedećim direktivama i standardima.

RO Noi, Nilfisk Prin prezenta declarăm pe propria răspundere, că produsul mai sus menționat este în conformitate cu următoarele standarde și directive.

ES Nosotros, Nilfisk declaramos bajo nuestra única responsabilidad que el producto antes mencionado está en conformidad con las siguientes directivas y normas

IT Noi, Nilfisk dichiariamo sotto la propria responsabilità, che il prodotto di cui sopra è conforme alle seguenti direttive e norme.

SV Vi Nilfisk förklarar härmed under eget ansvar att ovan nämnda produkt överensstämmer med följande direktiv och normer.

ET Meie, Nilfisk Käesolevaga kinnitame ja kanname ainuisikulist vastutust, et eespool nimetatud toode on kooskõlas järgmistele direktiivide ja

LT Mes, „Nilfisk“, prisiimdami visišką atsakomybę pareiškiame, kad pirmiau minėtas produktas (-ai) atitinka šias direktyvas ir standartus

SK My, Nilfisk prehlasujeme na svoju výlučnú zodpovednosť, že vyššie uvedený výrobok je v zhode s nasledujúcimi smernicami a normami.

FR Nilfisk déclare sous notre seule responsabilité que le produit mentionné ci-dessus est conforme aux directives et normes suivantes.

LV Mēs, Nilfisk, ar pilnu atbildību apliecinām, ka iepriekšminētais produkts atbilst šādām direktīvām un standartiem

SL Mi, Nilfisk izjavljamo s polno odgovornostjo, da je zgoraj omenjeni izdelek v skladu z naslednjimi smernicami in standardi.

FI Me, Nilfisk täten vakuutamme omalla vastuulla, että edellä mainittu tuote on yhdenmukainen seuraavien direktiivien ja standardien mukaisesti

NO Vi, Nilfisk erklærer herved under eget ansvar, at det ovennevnte produktet er i samsvar med følgende direktiver og standarder

TR Nilfisk, burada yer alan tüm sorumluluklarımıza göre, yukarıda belirtilen ürünün aşağıdaki direktifler ve standartlara uygun olduğunu beyan ederiz.

2006/42/EC

EN 60335-1:2012+A11:2014+A13:2017+A1:2019+A14:2019+A2:2019+A15:2021+A16:2023
EN 60335-2-72:2012

2014/30/EU

EN 61000-3-2:2019+A1:2021+A2:2024
EN 61000-3-3:2013+A1:2019+A2:2021
EN 61000-6-2:2019
EN 61000-6-4:2019
EN 61000-6-8:2020

Authorized to compile Technical File and
signatory:

March 20, 2025

Warner Guo, VP R&D, Head of Competence
Center APAC • R&D

Weilma (Warner) Guo

Contents

Introduction	2
Guide Purpose and Contents	2
How to Keep the Manual	2
Declaration of Conformity	2
Accessories and Maintenance	2
Changes and Improvements	2
Scope of Application	3
Machine Identification Data	3
Transport and Unpacking	3
Safety	3
Safety Symbols on the Machine	3
Safety Symbols in the Manual	4
General Safety Instruction	4
Machine Description	6
Machine Components *--Optional Parts	6
Control Panel	8
Technical Parameters	12
User Guide	13
Battery check/setting on a new machine	13
Battery type setting	14
Before Starting the Machine	15
Starting and Stopping the Machine	16
Parking Brake	16
Machine Operation	17
Hopper	17
Side Broom Installation	18
Spray Flow Setting	18
After Using the Machine	19
Towing/Pushing the Machine	19
Long-Term Storage	19
First Use	19
Maintenance	19
Scheduled Maintenance Table	20
Battery Charging	21

Introduction

Warning!



For general information or additional details not included in this manual, please scan the QR code on the right to view the instructions.



Notes

The numbers in parentheses can be found in the corresponding illustrations.



Guide Purpose and Contents

This manual is intended to provide the necessary information for the correct and safe use of the machine. The information includes the machine's technical data, safety, operation, storage, maintenance, accessories, and disposal instructions.

Before performing any operation or maintenance steps on the machine, both the operator and qualified technicians must read this manual carefully.

For any questions regarding the interpretation of this manual or if more information is needed, please feel free to contact our after-sales service department or distributor.

How to Keep the Manual

This manual must be kept near the machine for easy access. To avoid contamination or damage from liquids or other substances, store the manual in an appropriate bag or box.

Declaration of Conformity

The Declaration of Conformity applies to this machine and ensures that the machine complies with legally mandatory requirements.



Notes

A copy of the original Declaration of Conformity is provided along with machine documentation.

Accessories and Maintenance

All the necessary operations, maintenance, and repair procedures must be carried out by qualified personnel or an authorized service center designated by our company. Only original or approved spare parts and accessories can be used.

For any service or purchase of accessories or spare parts, please contact our company and provide the machine's model and serial number.

Changes and Improvements

Our company is committed to continuous product improvement and reserves the right to make changes and improvements to products already sold without prior notice.

Scope of Application

The machine applies to commercial and industrial use. It is suitable for cleaning smooth and solid floor (sweeping and debris collection). It must be operated by qualified personnel in safe circumstances.

Machine Identification Data

The model and serial number of this machine are marked on the serial number label. This information is crucial. Use the following table to write down the machine identification data when requiring spare parts for the machine.

Machine Model:
Machine Serial Number:

Transport and Unpacking

When receiving the machine, please check that the packaging and machine are intact. If any damage is found, ensure that the delivery personnel are informed and that the damage is documented in writing before accepting the delivery, retaining the right to claim compensation for any damages.

Follow the instructions on packing strictly when unpacking the machine.

Check the package to ensure following items are included:

- 1. Technical documentations - Instruction for Use
- 2. Battery connection cables.
- 3. Charger manual (if installed) (*).

Safety

The following symbols indicate potential hazards. Please carefully read this information and take necessary precautions to avoid possible personal injury or property damage.

Safety Symbols on the Machine

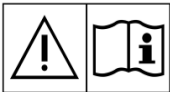

Warning!
Read all the instructions carefully before performing any operation on the machine.



Warning!
Do not wash the machine with direct or pressurized water jets.

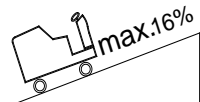

Warning!
Do not use the machine on slopes with gradients exceeding the specified limit.

Safety Symbols in the Manual



Danger!

This indicates a danger that could cause operator death.



Warning!

This indicates a potential danger that could harm personnel or equipment.



Caution!

This indicates a warning about important matters or useful functions. Pay attention to paragraphs with this symbol.



Note

This indicates a suggestion about important matters or useful functions.



Consultation

It indicates the necessity to refer to the Instruction for Use manual before performing any procedure.

General Safety Instruction

Specific warnings and cautions to inform about potential damages to people and machine are shown below.



Danger!

- This machine must be operated by trained and authorized personnel according to guidance of the manual.
- Before performing any usage, maintenance, repair, or parts replacement, ensure you have thoroughly read the manual, the machine is turned off, and the battery is disconnected.
- Do not use this machine near toxic, hazardous, flammable, or explosive dust, liquids, or vapors. This machine is not suitable for cleaning hazardous dust.
- Do not wear jewelry or accessories when working near electrical components.
- Do not work underneath the machine unless it is securely supported.
- When using a wet cell battery, the battery may release flammable gases during normal operation; keep away from open flames, sparks, strong light, or hot objects.
- When using a wet cell battery, the battery may release small amounts of hydrogen gas; ensure the charging environment is well-ventilated and far from open flames.



Warning!

- This machine is intended for commercial use, such as in hotels, schools, hospitals, factories, stores, offices, and rental businesses.
- When the machine is not in use, it should be secured to prevent accidental movement.
- To prevent unauthorized use, the machine's power should be turned off or locked, such as by removing the key switch.
- Before each use, carefully inspect the machine to ensure all parts are correctly installed; otherwise, it may pose a risk to people or property.
- Before charging the battery with the charger, ensure the power frequency and voltage match those indicated on the machine's serial number label.
- Do not pull the charger cord to move the machine. Do not allow the cord to pass through a closed door, and do not wrap it around objects with sharp edges or corners. Do not let the machine roll over the power cord. Keep the charger cord away from hot surfaces.
- If the charger cord or plug is damaged, do not charge the machine.
- To avoid fire, electric shock, or personal injury, ensure the machine is turned off when not in use.

- This machine is not suitable for outdoor use and is only intended for indoor use. Store it in a dry indoor environment when not in use.
- The storage and operating temperature of the machine must be between 0°C and +40°C, with environmental humidity maintained between 30% and 95%.
- Do not use the machine on slopes exceeding the specified gradient.
- When using floor cleaning liquids, follow the instructions on the cleaning solution bottle and wear appropriate gloves and other protective gear.
- Use only the side brooms, main brooms, and components specified in the user manual that come with the machine. Using other side brooms or main brooms may reduce safety.
- If the machine malfunctions, ensure that it is not due to a lack of maintenance. In case of other issues, seek assistance from authorized personnel or a service center.
- Take all necessary precautions to avoid the risk of hair, jewelry, and loose clothing being caught in the machine's moving parts.
- Do not use the machine in areas with excessive dust accumulation.
- Do not wash the machine directly with water or high-pressure water guns and avoid using corrosive substances for cleaning.
- Avoid collisions with surrounding objects while using the machine, especially if the collision could cause falling objects.
- When the machine is stationary, stop using the side brooms and main brooms to prevent floor damage.
- In the event of a fire, use a dry powder extinguisher. Do not use liquid extinguishers.
- Do not remove or alter the labels on the machine.
- Do not attempt to modify the machine's safety protections. Always follow the maintenance guidelines.
- Pay special attention when transporting the machine in temperatures below 0°C. If there is water in the tank or pipes, it may freeze and cause severe damage.
- If parts need to be replaced, obtain original parts from authorized dealers or agents.
- If the machine is damaged, placed outdoors, or submerged in water and is not functioning properly, send the machine to a service center.
- To ensure safe and correct operation, have authorized personnel or a service center perform regular maintenance according to the maintenance schedule in the relevant sections of the manual.
- The machine must be properly disposed of, as it contains toxic and harmful materials (such as batteries), which must be disposed of at specific centers in accordance with relevant regulations (see the disposal section).
- This machine is intended solely as a cleaning tool and should not be used for any other purpose.
- Keep the work area clear. Do not use the machine in areas where pathways are blocked. Ensure that the airways are not blocked by dust, hair, or any other objects that may obstruct airflow.
- Use the machine in well-lit areas.
- The machine should only be operated by properly trained or authorized personnel. Children or unauthorized individuals should not operate the machine.
- Extra caution must be taken when using the machine near children.
- Ensure that children do not play with the machine to avoid accidents.
- When using the machine, avoid causing harm to people or objects.
- Children should not clean or maintain the machine without adult supervision.
- Operators should be adequately instructed on how to use the machine.
- Do not use the machine in environments where there is a high risk of falling objects hitting the operator and the machine is not equipped with a canopy (FOPS).
- The headlights are only for improving the visibility of the surface being cleaned and should not be used in dark environments.
- Prevent the machine from being exposed to direct sunlight, rain, or harsh weather conditions, whether it is operating or not. Store the machine in a dry indoor environment: the machine must be used in a dry environment and should not be used or stored in damp outdoor conditions.
- Adjust the operating speed based on the ground conditions.
- When the machine is going downhill, drive at low speed to avoid sudden stops. Avoid sharp turns.
- This machine should not be used on roads or public streets.
- The recommended maximum weight of the operator for this equipment is 120kg (265lbs), as recommended for optimal safety and machine performance. Operating the equipment outside of this range may compromise safety and durability. Ensuring safer operation, the operator of the machine must fit within the confines of the equipment. Please consult your supervisor or equipment manufacturer for specific concerns.

Machine Description

Machine Components *--Optional Parts

1. Turn indicator
2. Air outlet bracket
3. Filter compartment cover
4. Knurled knob
5. Hopper
6. Latch
7. Steering wheel
8. Control panel
9. Emergency stop switch
10. USB port
11. Main broom adjustment knob
12. Phone bag
13. Accelerator pedal
14. Auxiliary hole of the machine
15. Chassis
16. Right cover
17. Blade
18. Rear wheels
19. Internal/external charging port
20. Warning light
21. Seat (with seat switch)
22. Blue light (*)
23. Logo label
24. Head lamp
25. Operating indicator
26. Spray nozzle
27. Right bumper
28. Side broom
29. Front wheel
30. Cover
31. Left bumper
32. Water level indicator
33. Parking brake
34. Flap pedal
35. Left side panel
36. Cup holder
37. Cover

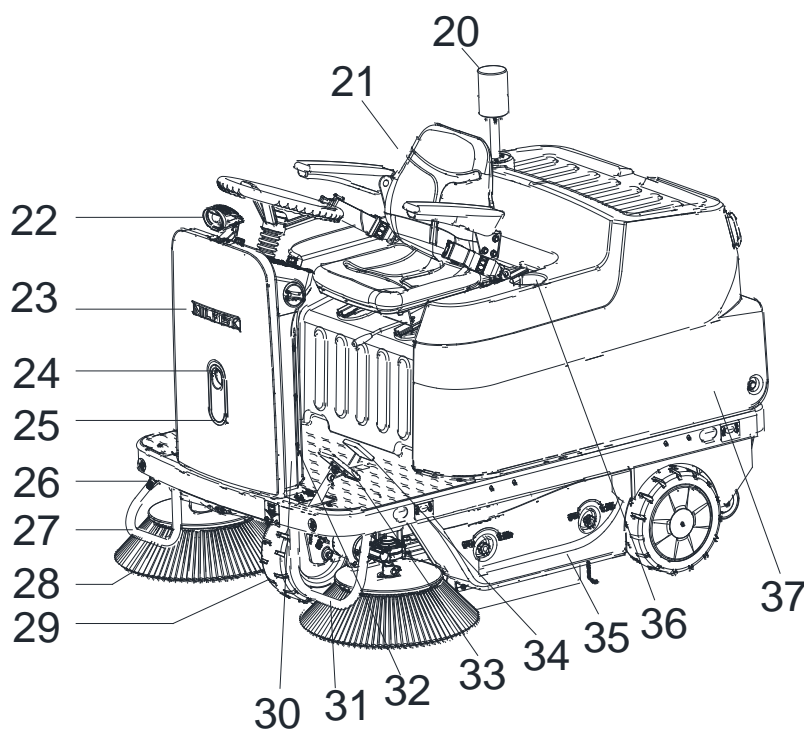
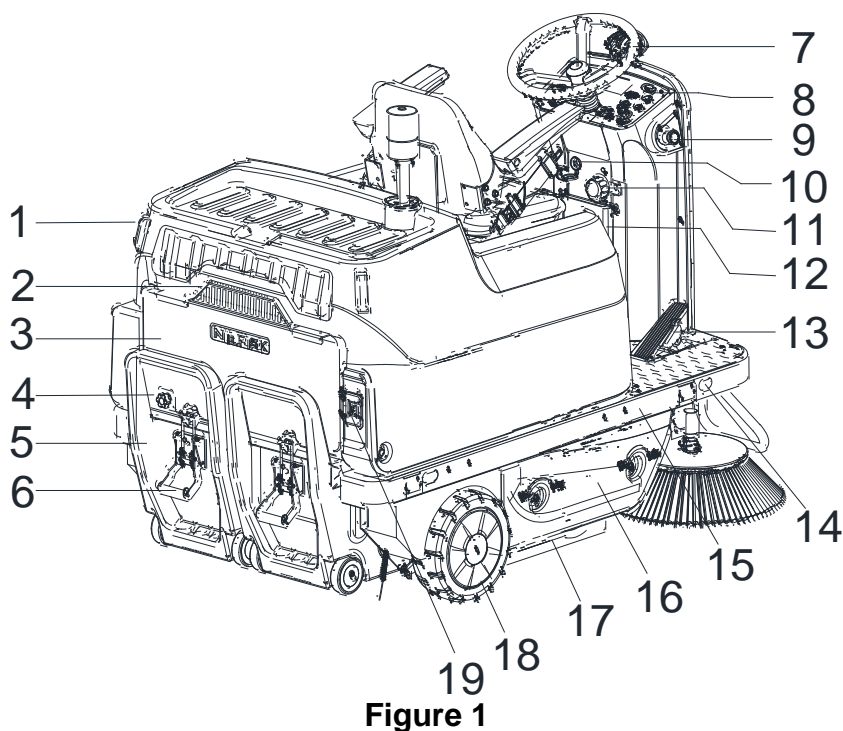

- 38. Hood support cable
- 39. Circuit breaker box
- 40. Battery connector
- 41. Battery (*)
- 42. On-board charger (*)
- 43. Auto brake
- 44. Battery tray
- 45. Main broom

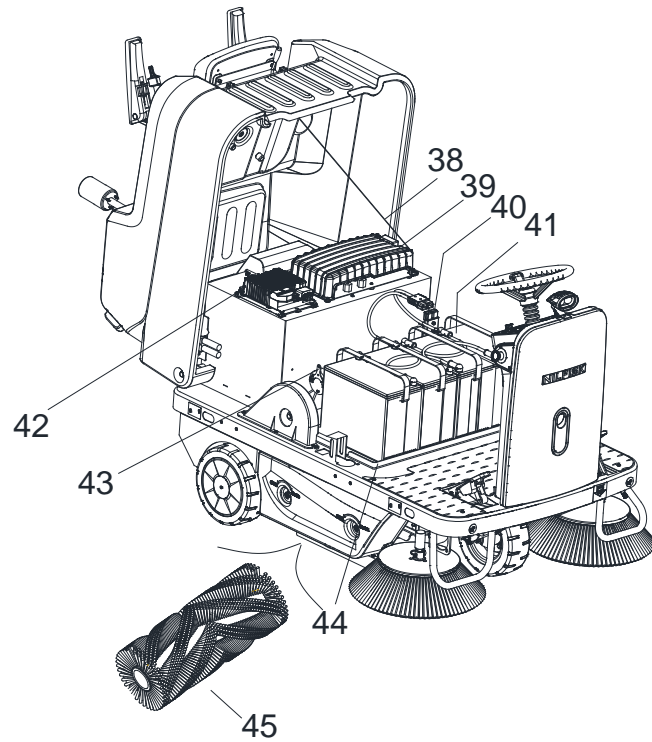

Figure 3

Control Panel

46. Multifunctional display

Items displayed:

- A) Login screen
- B) Home screen
- C) Menu screen
- D) Safety stop mode
- E) Reverse mode
- F) Brake mode
- G) Operating time
- H) Battery level

I) On the login screen, use the indicator left button(56) to delete the incorrect password

J) On the login screen, use the start button(47) to confirm the password

K) Dust fan status

L) Filter shaker status

M) Side broom status

N) Press the start button(47) to enable cleaning mode.

O) Dust guard spray status

P) On the menu screen, short press ① to return to the previous page

Q) On the menu screen, short press the indicator left button(56) to scroll down the item.

R) On the menu screen, short press the indicator right button(57) to scroll up the item

S) On the menu screen, short press ② to confirm the option

47. Start button

Turn on/off cleaning mode, turning on cleaning mode will automatically activate the main broom, side brooms, and dust fan.

48. Dust fan button

49. Filter shaker button

- Enable/Disable dustproof function
- Press for 2 seconds to activate automatic mode (Filter shaker LED flashes), press for 2 seconds again to exit the automatic mode.

50. Side broom button

51. Dust guard spray button

52. Side broom speed dial

53. Power button

54. 4-digit pin pad

55. Machine speed dial

56. Indicator left button

57. Indicator right button

58. Reverse button

59. Headlight button

60. Horn button

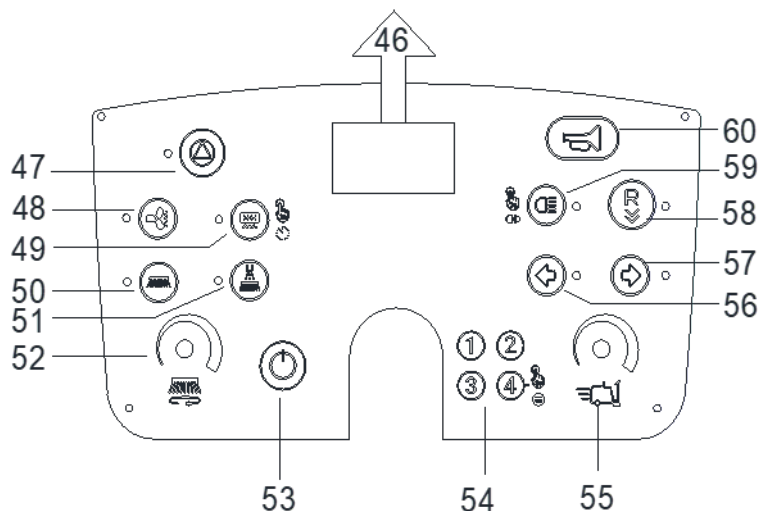
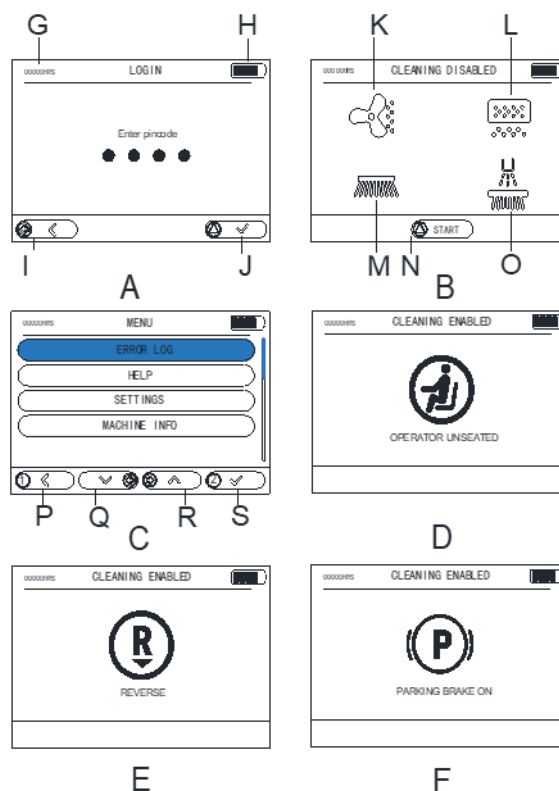
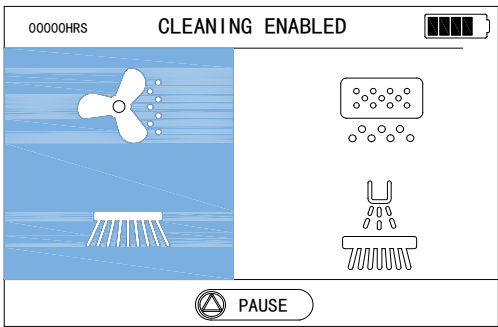

Figure 4

Working Mode Description

Operation Mode	Screen Display	State Description
Login Interface		
<div><div>- Press the power button (53) to enter the startup interface, which will then automatically switch to the login interface.</div><div>- Use the 4-digit pin pad (54) to enter a 4-digit password. The default password is 1234, and users can change the password in Settings.</div></div>		<div><div>1. The top-left corner of the LCD screen displays the machine's operating time.</div><div>2. The top-right corner of the LCD screen displays the battery level.</div><div>3. The main title on the LCD screen is LOGIN.</div><div>4. As user inputs the password, the interface changes according to the entered digits.</div><div>5. If the password is entered incorrectly, user can use the indicator left button (56) to delete the incorrect password.</div><div>6. After entering the 4-digit password, press the start button (47) to confirm and log in with the entered password. If the password is correct, the Home interface will appear. If incorrect, the password error interface will appear, and after 2 seconds, it will return to the password input interface.</div><div>7. If the password is entered incorrectly five times in a row, the machine will lock for 5 minutes. After 5 minutes, the login interface will appear again.</div></div>
Home Interface		
<div><div>- Press the power button (53).</div><div>- Login successful.</div></div>		<div><div>1. The operating time does not start timing.</div><div>2. The main title on the LCD screen is CLEANING DISABLED.</div><div>3. Cleaning is disabled. The main broom, side broom, dust fan, and dust guard spray functions are disabled, and the icons for the side broom, dust fan, and dust guard spray are dimmed.</div><div>4. The filter shaker icon is highlighted, and the filter shaker function is enabled.</div><div>5. Short press the filter shaker button(49), the filter shaker LED indicator is steady on, and the background of the filter shaker icon is highlighted. After one working cycle, the filter shaker automatically stops, the LED turns off, and the background of the filter shaker icon returns to low brightness.</div><div>6. Press the filter shaker button for 2 seconds, it will enter the automatic mod, the filter shaker LED indicator flashes.</div></div>
Cleaning mode		
<div><div>- Press the power button (53).</div><div>- Login successful.</div><div>- Press the start button (47).</div></div>		<div><div>1. The operating time does not start timing.</div><div>2. The main title on the LCD screen is CLEANING ENABLED.</div><div>3. The main broom, side broom, and dust fan are automatically activated. The main broom and side broom drop to the ground, the backgrounds of dust fan and side broom icons are highlighted, and the LED indicators are steady on.</div><div>4. Filter shaker and dust guard spray functions are turned off by default, but the filter shaker and dust guard spray icons are highlighted, allowing the user to manually turn them on.</div></div>

- Press the power button (53).
- Successful login.
- Press the start button (47).
- Seat safety switch (21) turned on (sit on the seat).
- Press the accelerator pedal (54).



1. The operating time start timing.
2. The main title on the LCD screen is **CLEANING ENABLED**.
3. The main broom, side broom, and dust fan start working.
4. If the dust guard spray is turned on and there is water in the water tank, the dust guard spray starts work.
5. If the filter shaker function is enabled, the filter shaker motor will operate. When the filter shaker motor is working, the fan will automatically stop. Once the filter shaker motor stops, the fan will automatically resume working.

Menu Interface

- Press the power button (53).
- Successful login.
- Press the button ④ of 4-digit pin pad (54) for 2 seconds

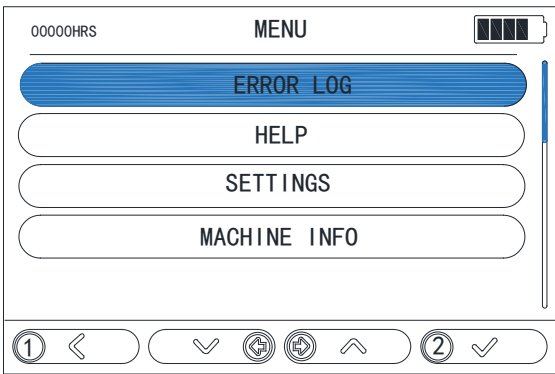

1. The operating time does not start timing.
2. The main title on the LCD screen is **MENU**.
3. The MENU includes **ERROR LOG**, **HELP**, **SETTINGS**, and **MACHINE INFO**.
4. Use the button ① of 4-digit pin pad (54) to return to the previous screen, use the indicator left button (56) to scroll down, use the indicator right button (57) to scroll up, and use button ② to confirm a selection.
5. **ERROR LOG** allows user to view the list of error messages.
6. **HELP** provides service information.
7. **MACHINE INFO** allows user to view product information.

Reverse Mode

- Press the power button (53).
- Successful login.
- Seat safety switch (21) turned on (sit on the seat).
- Press the reverse button (58).

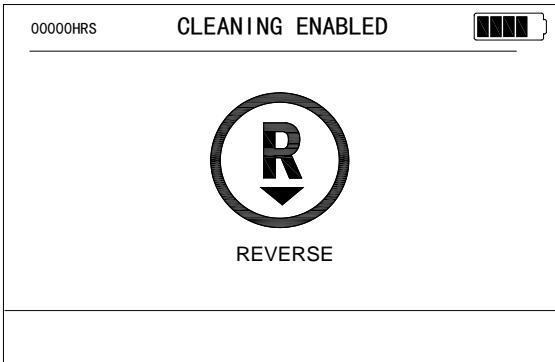

The horn sounds a "beep beep..." to indicate a reverse warning.

Brake/Park Mode

- Press the power button (53).
- Successful login.
- Seat safety switch (21) turned on (sit on the seat).
- Press the brake (33).

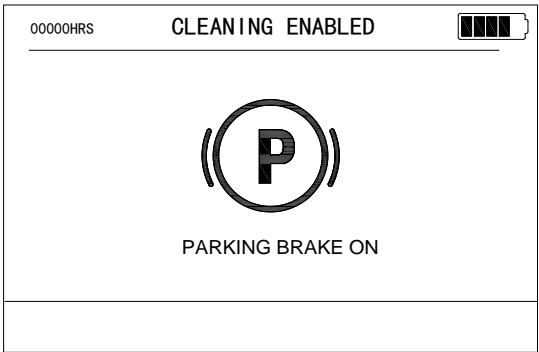

The machine stops moving, and other functions remain in their current state.

Operation Mode	Screen Display	State Description
Safe Stop Mode		

<div><div><div><div><div></div><div></div><div></div><div></div></div><div><div></div><div></div><div></div><div></div></div></div><div><div><div></div><div></div><div></div><div></div></div><div><div></div><div></div><div></div><div></div></div></div><div><div><div></div><div></div><div></div><div></div></div><div><div></div><div></div><div></div><div></div></div></div><div><div><div></div><div></div><div></div><div></div></div><div><div></div><div></div><div></div><div></div></div></div></div><div><div><div></div><div></div><div></div><div></div></div><div><div></div><div></div><div></div><div></div></div></div><div><div><div></div><div></div><div></div><div></div></div><div><div></div><div></div><div></div><div></div></div></div></div>
--

GB Technical Parameters

Technical Parameters	Value
Machine length	1620 mm/63.8 Inches
Machine width (without side brooms)	1055 mm/41.5 Inches
Machine height	1260 mm/49.6 Inches
Machine height with overhead guard	1986mm/78.2 Inches
Working width (without side brooms)	700 mm/27.6 Inches
Working width (with two side brooms)	1350 mm /53.1 Inches
Minimum ground clearance (excluding blades)	60 mm/2.4 Inches
Main broom size (diameter x length)	300x700 mm/11.8x27.6 Inches
Side broom size (mm/Inches)	500 mm/19.7 Inches
Main broom speed (rpm)	600 rpm
Side broom speed (rpm)	0~98rpm
Front wheel ground pressure per unit area (N/mm ²)	0.88 N/mm ²
Rear wheel ground pressure per unit area (N/mm ²)	0.6 N/mm ²
Machine weight (without battery) (kg)	361 kg
Machine gross weight (GVW) (kg) without operator	563 kg
Hopper volume (l)	100L
Main broom motor	Input 624W Output 500W
Side broom motor	Input 280W Output 100W x 2
Drive motor	Input 936W Output 650W
Suction Motor	Input 168W
Water pump	Input 30W
Actuator	Input 60W x 2
Filter shaker motor	Input 144W
Others	Input 58W
Rated power	2640W
Power consumption	948W/1.3HP(Lead-acid) 823W/1.1HP(Li-ION)
Noise level (ISO 11201, ISO 4871) (LpA)	72±3 dB(A)
Sound power (ISO 3744, ISO 4871) (LwA)	86 dB(A)
Vibration level at the operator's arms (ISO 5349-1) (*)	<2.5m/s ²
Vibration level at the operator's body (ISO 2631-1) (*)	<0.5 m/s ²
Motor protection rating	IP24
(*) Performance parameters under normal working conditions on a flat asphalt surface	
Performance	Value
Maximum driving speed	8 km/h
Maximum reverse speed	4 km/h
Gradeability	16% (L=140 meters)
Minimum turning radius width	2550 mm
Battery	Value
Battery voltage	24 V
Battery compartment dimensions (length x width x height)	770 x 340 x 300 (mm)
Dust collection and filtration	
Dust filter size	3.5 m ²
Main broom compartment vacuum	8.8 mm H ₂ O
Filter shaker	Electric

User Guide



- Warning!**
There are warning labels on certain parts of the machine:
- Danger!
 - Warning!
 - Caution!
 - Recommendation

Operators must pay special attention to these symbols on the labels when reading this manual. Under no circumstances should these labels be covered. If they are damaged, replace them immediately.

Battery check/setting on a new machine



WARNING!
The electric components of the machine can be seriously damaged if the batteries are either improperly installed or connected. The batteries must be installed by qualified personnel only. Set battery type using the procedures below according to the type of batteries used (WET or GEL/AGM/DIS/EXI/FUL/OPT/ENE(TPPL)). Check the batteries for damage before installation. Disconnect battery connector and battery charger plug. Handle the batteries with great care. Install the battery terminal protection caps supplied with the machine.



NOTE
The machine requires four 6V batteries, connected and installed in the positions shown in Figure 5.

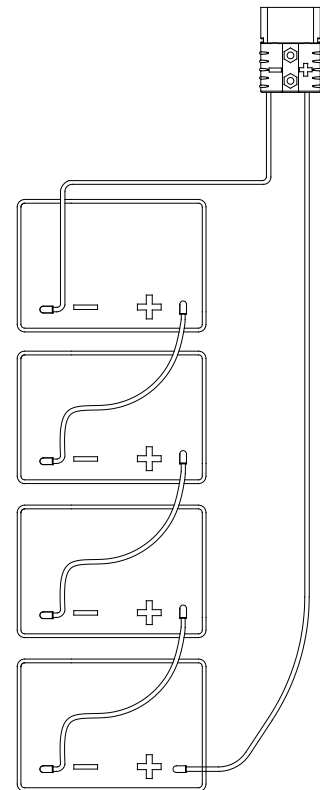

Figure 5

Batteries already installed on the machine

1. Ensure that the battery connector is connected.
2. When first using the machine with new batteries, perform a full charging cycle (see the procedures in Maintenance chapter).

Without batteries

1. Buy appropriate batteries (see “Technical Data” chapter). For battery choice and installation, contact qualified battery retailers.
2. Set battery type according to the procedures below.

Battery type setting

The machine battery type setting is as follows:

1. Press the power button (A, Figure 6).
2. Use the 4-digit pin pad (C, Figure 6) to enter the password. The default password is 1234.
3. After successfully logging in, press and hold ④ button (D, Figure 6) for 2 seconds to enter the MENU interface (K, Figure 6).
4. In the MENU interface, press ① button (B, Figure 6) to go back to the previous menu, press indicator left button (G, Figure 6) to scroll down, press indicator right button (F, Figure 6) to scroll up, select "SETTINGS", then press ② button (E, Figure 6) to confirm the selection and enter the SETTINGS interface (J, Figure 6).
5. In the SETTINGS interface (J, Figure 6), select (I, Figure 6) BATTERY TYPE to enter the BATTERY TYPE settings interface (H, Figure 6).
6. Press indicator left button (G, Figure 6) to scroll down, press indicator right (F, Figure 6) to scroll up, choose the battery type according to the batteries are installed, then press ② button (E, Figure 6) to update the change.
7. The battery selection will set the charging profile if using the onboard charger.
8. Attention, using an external charger, both the machine and the charger must be set according to batteries installed.

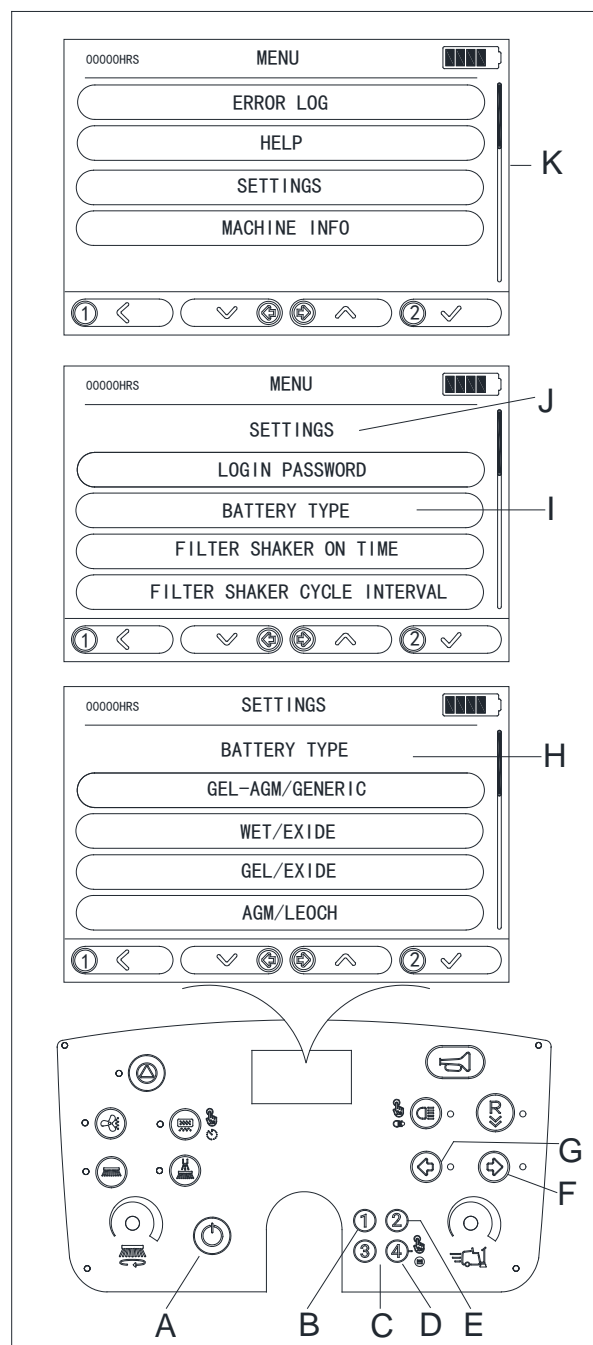

Figure6

Before Starting the Machine

Checklist

9. Fully understand all the control functions of the machine.
10. Sit on the seat (A, Figure 7), and press the power button (G, Figure 7) to start the machine (see the following operating procedure section).
11. Check the battery charge. If the LCD (H, Figure 7) shows the battery icon with 5 bars, it means the battery is fully charged and the machine can be used. If the LCD (H, Figure 7) shows the battery icon with 1 bar or less, the battery needs to be charged. (Refer to the maintenance section for battery charging.)
12. Check the brake (B, Figure 7). The brake must be locked and easy to release (if there are issues, consult the service center).
13. Check the front panel pedal (D, Figure 7) for smooth operation.
14. Press the accelerator pedal (E, Figure 7) to check if the machine can move forward or stop.
15. To ensure the machine's safety, pressing the emergency stop switch (C, Figure 7) will immediately stop the machine. Rotate the emergency stop switch to reset it. If you want to continue using the machine, you need to restart it to exit the emergency stop mode.



Warning!

If the brake pedal feels weak or ineffective when pressed, and the machine cannot be stopped (contact the service center immediately).

16. Ensure the cover and hopper are both closed before operating the machine.
17. Ensure the latch of the hopper (F, Figure 7) is securely fastened.

Cleaning Plan

1. Schedule long operation times, as well as start and stop times.
2. Allow slight overlap of cleaning paths to ensure complete coverage.
3. Avoid sharp turns, collisions, or scraping the machine's sides.

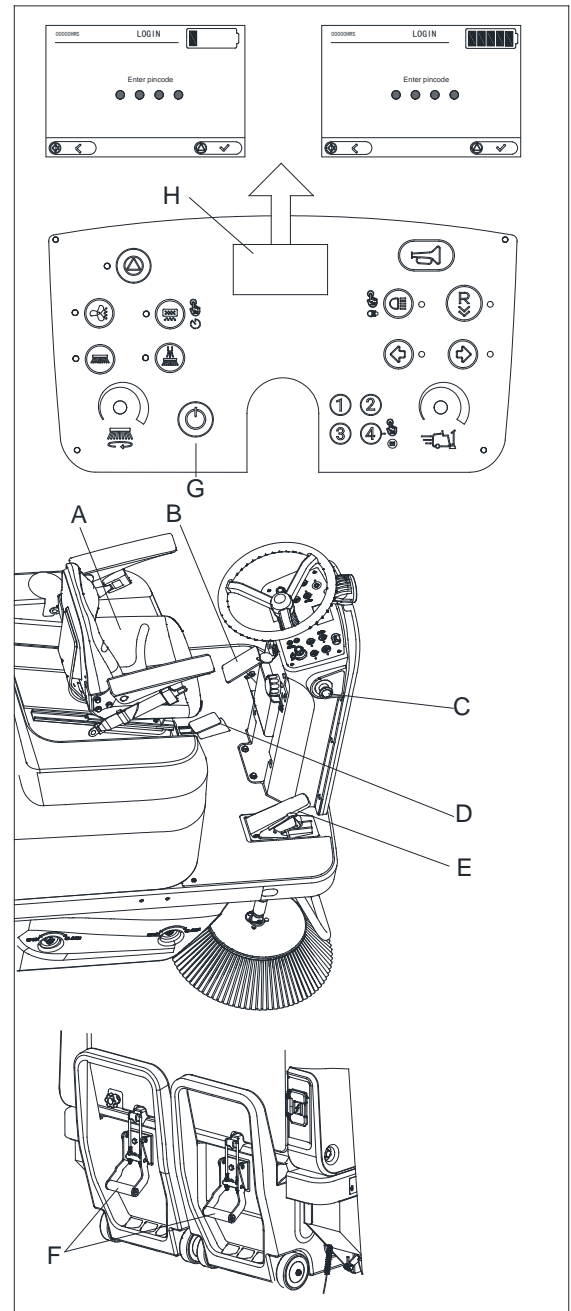

Figure 7

Starting and Stopping the Machine

Starting the machine

1. Sit on the driver's seat (A, Figure 8) and adjust its position with the lever (C, Figure 8) to allow easy reach of all controls.
2. Press the power button (M, Figure 8). Check the battery level on the display. If needed, charge the battery (refer to the maintenance section).
3. Use the 4-digit pin pad (L, Figure 8) to enter the password. The default password is 1234.
4. After successfully logging in, release the brake (E, Figure 8), press the accelerator pedal (G, Figure 8) and drive the machine to the work area.
5. Press the start button (H, Figure 8) to start the cleaning mode. The side brooms and main broom will automatically lower to the ground, and the dust fan will start working.
6. Press the accelerator pedal (G, Figure 8), and steer the machine by holding the steering wheel (C, Figure 8) while pressing the reverse button (J, Figure 8) to drive the machine forward or backward. Adjust the driving speed using the machine speed dial (K, Figure 8).
7. Adjust the side broom speed using the side broom speed dial (N, Figure 8) according to cleaning requirements.
8. When the machine is on, you can charge devices such as a phone or pad via the USB charging port (D, Figure 8).
9. Press the horn button (I, Figure 8) to warn people when necessary.



Note

The suction system of the machine will only operate when the main broom is lowered. The main broom and side brooms (P and O, Figure 8) can be lifted or lowered even while the machine is running. The main broom and side brooms do not rotate when they are lifted.

10. Start sweeping by turning the steering wheel (C, Figure 8) and driving the machine forward with the accelerator pedal (G, Figure 8).

Stopping the machine

11. Release the accelerator pedal (G, Figure 8) to stop the movement.
12. Press the start button (H, Figure 8) to turn off the main broom, side broom and dust fan. The main broom and side brooms are lifted from the floor automatically. The dust fan system is turned off after a delay of several seconds.
13. Engage the parking brake.

Parking Brake

1. Engage the parking brake by pressing on the front part of the pedal (A, Figure 9) and engaging the lever (B, Figure 9).
2. Press the rear part of the pedal (C, Figure 9) to release the parking brake.

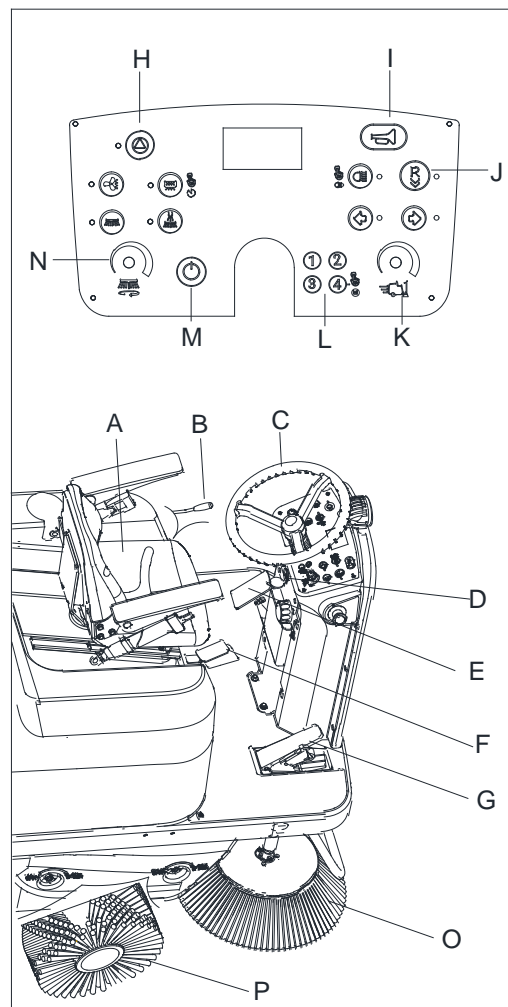

Figure 8

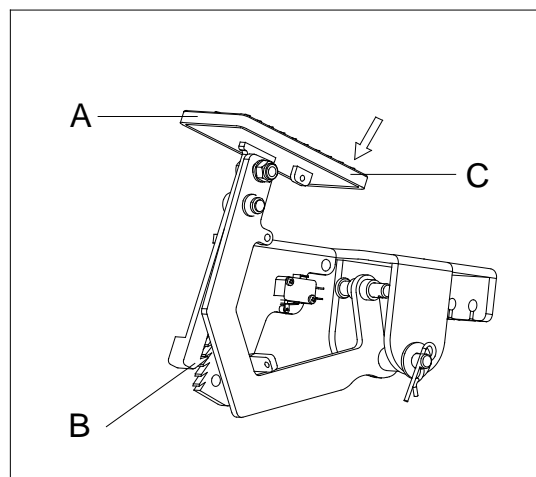

Figure 9



Warning!

Before performing any maintenance, repair, cleaning, or replacement procedures, engage the parking brake. When parking the machine on a slope, engage the parking brake.



Warning!

When the machine is unattended, ensure that the brake can safely stop the machine with a higher safety factor.

Machine Operation



Warning!

When using the machine on a slope, follow the maximum slope value marked on the machine (refer to the "Technical Data" section).



Warning!

Pay careful attention when operating the machine at high speed: sudden steering could cause this three-wheel machine to become unstable due to weight distribution. Always reduce the speed before steering.

1. Drive the machine to the work area as shown in the previous paragraph.
2. Drive the machine straight forward at high speed. Drive the machine slower when sweeping a large amount of dust or debris or when safe operation requires slower speed. To achieve optimal results, overlapping sweeping paths by over 10 cm is recommended.
3. Avoid stopping the machine in the same position for a long time with the brooms rotating, as this may leave unwanted marks on the floor.
4. To collect light and bulky waste materials, lift the front blade by pressing the flap pedal (F, Figure 8); take into consideration that the machine vacuum capability is reduced when the front blade is lifted.



Notes!

When operating on wet surfaces, press the dust fan button (A, Figure 10) to turn off the vacuum system to prevent damage to the dust filter.

5. For the machine to operate properly, the filter must be kept as clean as possible. Press the filter shaker button (B, Figure 10) to activate the dust shaking function. During this process, the vacuum motor will automatically turn off. After dust shaking, the vacuum system will automatically resume operation and then continue cleaning. During operation, press the filter shaker button (B, Figure 10) for 2 seconds to start the "Automatic Filter Dust Shaking" mode, which repeats the automatic dust shaking process every 10 minutes on average (the repetition interval can be modified in settings, and users can adjust it based on the dust level in the cleaning area).



Note!

This process can also be performed while the machine is moving.



Note!

The machine cannot collect dust and debris if the filter is clogged or the hopper is full.

6. The hopper (D, Figure 11) should be emptied after each working cycle and when it is full (see the next section).

Hopper

1. Stop the machine (see the previous sections for the procedure).
2. Engage the parking brake.
3. Disengage the latch (A, Figure 11) by pulling its lower end.
4. Remove the hopper by disengaging it from the inner guides with the handle (B, Figure 11).
5. Discharge all the debris into special containers. To make discharging procedure easier, there is an inner box with handle (C, Figure 11) inside the hopper.
6. Install the hopper (D, Figure 11), and engage it into the internal guides.
7. Fasten the latch (A, Figure 11). The machine is now ready to start cleaning again.

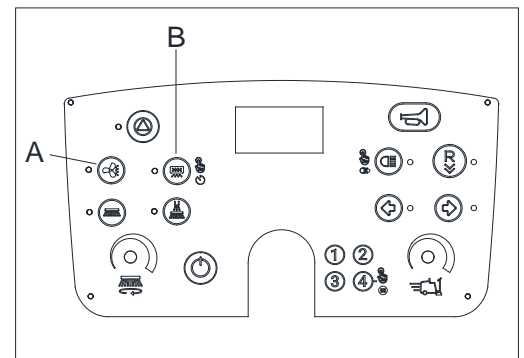

Figure 10

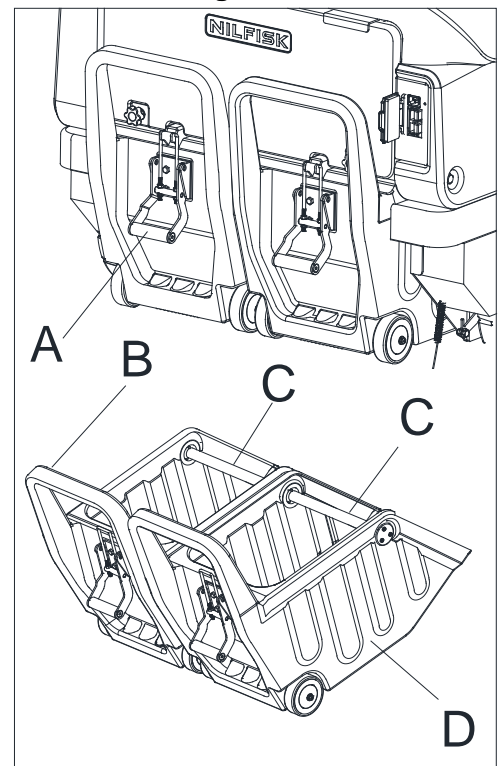

Figure 11

GB Side Broom Installation

1. Drive the machine onto level ground and press the parking pedal to park the machine.
2. Press the power button to turn off the machine.
3. Release the spring on the "D" pin (A, Figure 12), then remove the "D" pin from the side broom shaft (B, Figure 12).
4. Place the new side broom on the side broom motor shaft, align the holes on the side broom hub with the hole on the motor shaft (D, Figure 12), then insert the "D" pin (B, Figure 12) and finally fasten the spring (A, Figure 12).
5. Adjust the side broom height as described earlier.

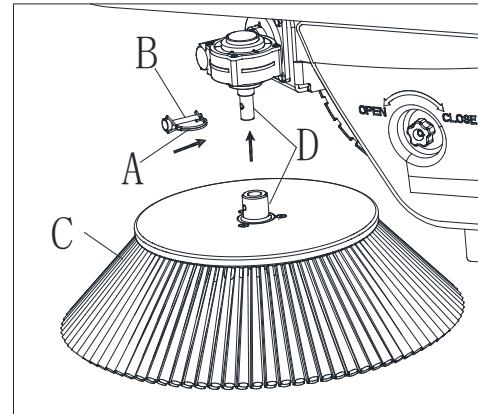

Figure 12

Spray Flow Setting

The machine settings are as follows:

1. Press the power button (A, Figure 13).
2. Use the 4-digit pin pad (C, Figure 13) to enter the password. The default password is 1234.
3. After successfully logging in, press and hold ④ button (D, Figure 13) for 2 seconds to enter the MENU interface (K, Figure 13).
4. In the MENU interface, press ① button (B, Figure 13) to go back to the previous menu, press indicator left button (G, Figure 13) to scroll down, press indicator right button (F, Figure 13) to scroll up, select "SETTINGS", then press ② button (E, Figure 13) to confirm the selection and enter the SETTINGS interface (J, Figure 13).
5. In the SETTINGS interface (J, Figure 13), select (I, Figure 13) WATER SPRAY to enter the WATER SPRAY settings interface (H, Figure 13).
6. Press indicator left button (G, Figure 13) to decrease the spray speed, press indicator right (F, Figure 13) to increase the spray speed, and adjust to the desired setting, then press ② button (E, Figure 13) to update the change.

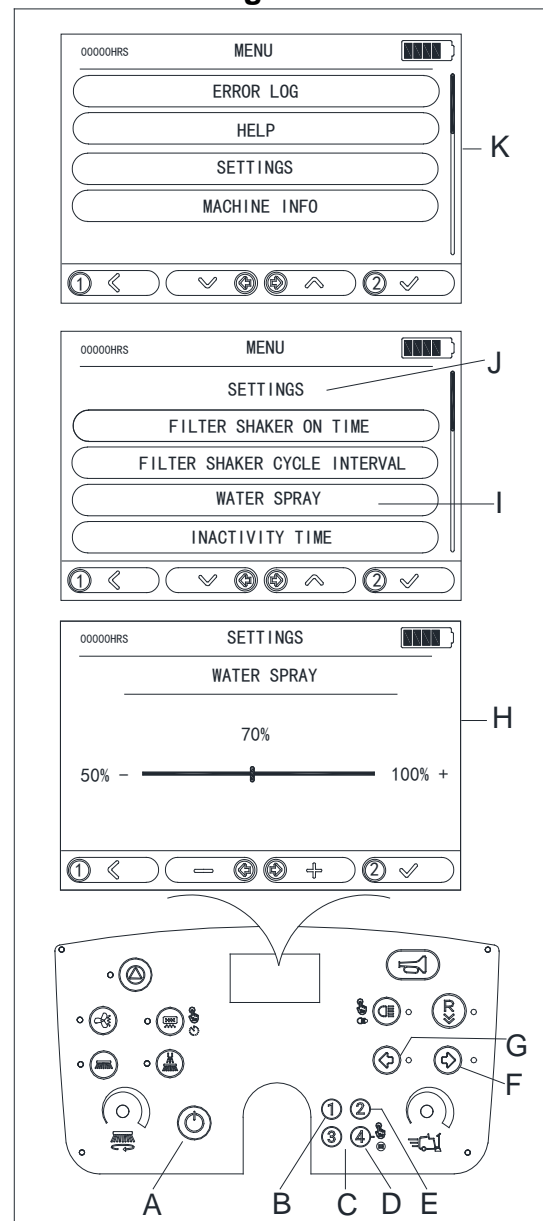

Figure 13

After Using the Machine

Once the cleaning work is completed, please follow these steps before leaving the machine:

1. Press the start button (C, Figure 14) to disable all cleaning motor functions (dust fan, side broom/main broom), and the side broom and main broom will be lifted.
2. Press the filter shaker button (B, Figure 14) to activate the dust shaking function and clean the filter.
3. Empty the hopper (D, Figure 11) (see the previous section for the steps).
4. Press the power button (A, Figure 14) to turn off the power.
5. Press the brake to park the machine.
6. If needed, charge the battery (refer to the maintenance section for the operating steps).
7. Complete the daily maintenance steps (refer to the maintenance section).
8. Store the machine in a dry and clean place.

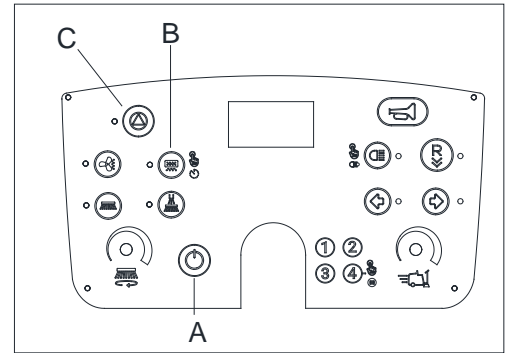

Figure 14

Towing/Pushing the Machine

Turn off the machine. To tow or push the machine, follow these steps:

1. Open the cover (A, Figure 15).
2. Pull the handle (B, Figure 15) of the drive motor outward.
3. Insert a screwdriver (C, Figure 15) into the slot (D, Figure 15). Close the cover, and then the machine can be pushed or towed.
4. When the machine reaches its destination, remove the screwdriver (C, Figure 15), and the machine will be able to operate normally.

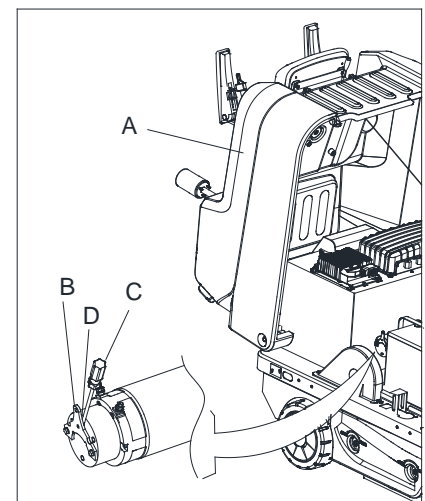

Figure 15

Long-Term Storage

If the machine will not be used for more than 30 days, please handle it as follows:

1. Complete all steps for "After machine use."
2. Disconnect the battery connector.
3. To avoid damage to the battery, if the machine is not used for more than 3 months, charge the battery every 3 months.

First Use

After the first 8 hours of use, check if any fasteners or connections are loose and check for visible damage or leaks.

Maintenance



Warning!

Maintenance procedures must be performed after the machine is turned off and the battery charger cable is disconnected. Before performing any maintenance steps, please carefully read the safety sections in the manual.

All scheduled or extraordinary maintenance procedures must be performed by qualified personnel or an authorized Service Center. This manual only describes the general and common maintenance procedures. For other maintenance procedures that are not in below maintenance schedule table, please contact our Technical Support Department.

Scheduled Maintenance Table

Procedure	After Delivery	Every 10 Hours	Every 50 Hours	Every 100 Hours	Every 200 Hours	Every 400 Hours
Battery charging	(1)					
Battery (WET) electrolyte level check		(2)				
Main broom cleaning						
Side and main broom height check and adjustment						
Dust filter cleaning and integrity check		(3)				
Blade height and operation check						
Filter shaker operation check			(*)			
Main broom drive belt visual inspection			(*)			
Flap pedal check and adjustment				(*) (4)		
Steering chain check and cleaning					(*)	
Main broom drive belt replacement					(*)	
Main broom motor and drive system motor carbon brushes check or replacement						(*)

- (*) For related procedures, refer to the *Service Manual*.
- Daily or after using the machine.
 - Before starting the machine.
 - Or more frequently in dusty areas.
 - If used on slopes, the maintenance frequency should be increased.

Battery Charging



Note
Please charge the battery when the battery level is low.



Caution!
Keeping the battery charged can extend its lifespan.



Caution!
Charge the battery as soon as it runs low, as failure to do so may shorten the battery's lifespan. Check the battery level at least once a week.



Warning!
During charging, wet-cell batteries emit flammable hydrogen gas. Ensure the charging area is well-ventilated and away from open flames. When charging, open the wastewater tank and avoid smoking near the charging battery accessories.



Warning!
Exercise special caution when charging the battery, as there may be leakage of acidic liquid during the charging process. Battery acid is corrosive. If accidentally contact with skin or eyes, rinse immediately with a large amount of water and seek medical attention. Do not operate the machine during the charging process.

Preparation steps

1. Drive the machine to the designated charging area.
2. Press the power button to turn off the machine (B, Figure 16).
3. Follow the steps below to charge the battery.

Battery charging (using an external charger)

4. Open the charging port protective cover (C, Figure 16). Connect the external charger's connector to the DC charging port on the machine (E, Figure 16). When the external charger is connected to the machine, all functions on the machine will automatically shut down.
5. Plug the AC power cord of the charger into the socket.
6. When charging is complete, first disconnect the charger from the power source, then disconnect it from the machine.
7. After charging is complete, check the battery electrolyte level (only for WET type batteries).
8. Press the power button to turn on the machine (B, Figure 16) and check the battery status on the panel display (A1, Figure 16).

Battery charging (using the on-board charger)

9. Open the charging port protective cover (C, Figure 16). Connect the power cable to the on-board charging port on the machine (D, Figure 16), then plug the other end of the power cable into the socket.
10. The battery charging status can be viewed on the LCD display (A2, Figure 16).
11. When charging is complete, unplug the power cable from the socket, then disconnect the power cable from the machine.
12. Check the battery electrolyte level (only for WET batteries).
13. Press the power button to turn on the machine (B, Figure 16) and check the battery status on the panel display (A1, Figure 16).

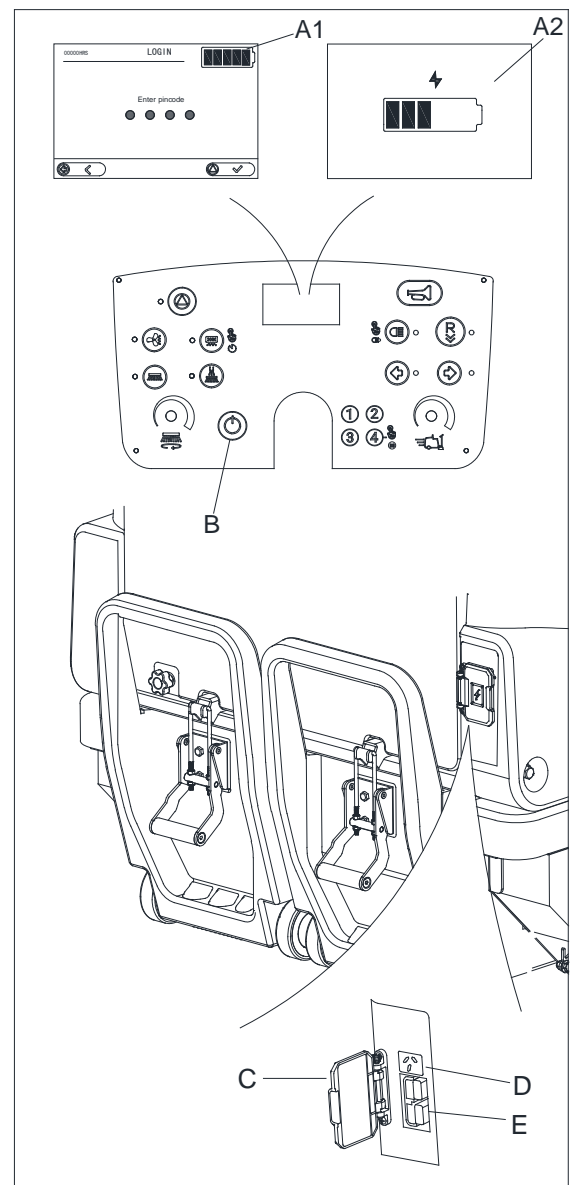

Figure 16

SW3000 Quick Start Guide is available in numerous other languages upon request.

SW3000 Quick Start Guide Video: <https://nilfisk.23video.com/secret/113007613/18a5f2a30194aaa4ec8681b3b874941c>